

# FILM-TECH

**THE INFORMATION CONTAINED IN THIS ADOBE ACROBAT PDF FILE IS PROVIDED AT YOUR OWN RISK AND GOOD JUDGMENT.**

**THESE MANUALS ARE DESIGNED TO FACILITATE THE EXCHANGE OF INFORMATION RELATED TO CINEMA PROJECTION AND FILM HANDLING, WITH NO WARRANTIES NOR OBLIGATIONS FROM THE AUTHORS, FOR QUALIFIED FIELD SERVICE ENGINEERS.**

**IF YOU ARE NOT A QUALIFIED TECHNICIAN, PLEASE MAKE NO ADJUSTMENTS TO ANYTHING YOU MAY READ ABOUT IN THESE ADOBE MANUAL DOWNLOADS.**

**[WWW.FILM-TECH.COM](http://WWW.FILM-TECH.COM)**



AUTHORIZED DISTRIBUTOR:  
**JARCO INDUSTRIES**  
TOLL FREE ORDERING 800-458-7578  
WWW.CONCESSIONSTANDS.COM

Part No. 79064  
Revised June 1996

# *Accu-Meter Oil Pump*

Instruction Manual  
Model #2114

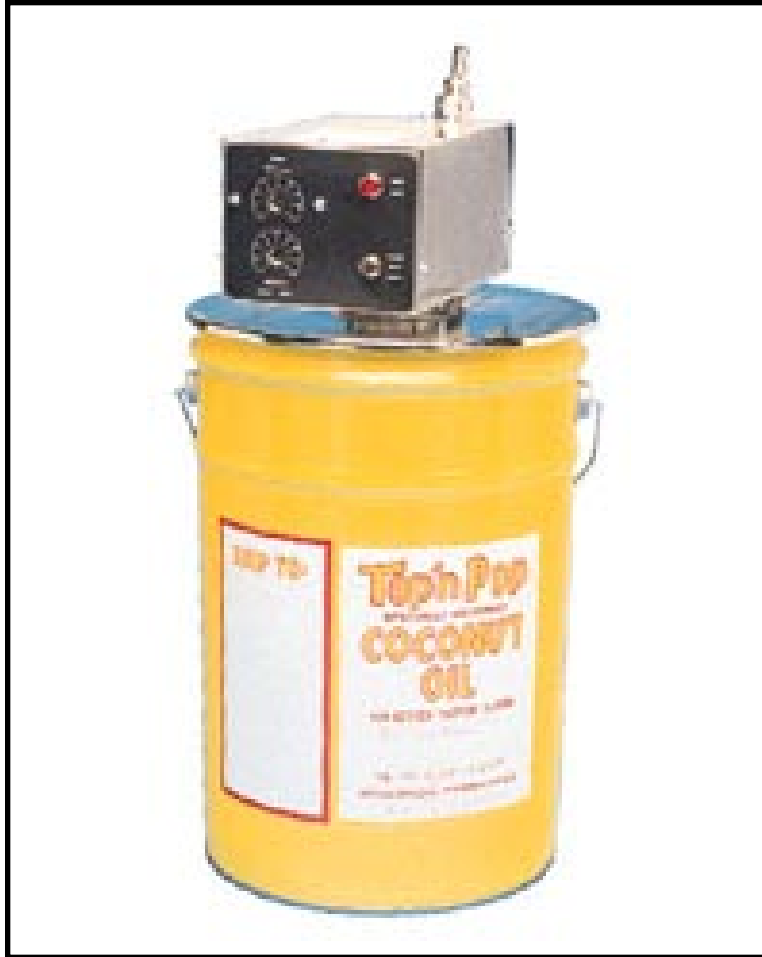



# **GOLD MEDAL<sup>®</sup>**

**FUNFOOD EQUIPMENT & SUPPLIES**

Cincinnati, OH 45241-4807 USA

# SAFETY PRECAUTIONS

	<b>⚠ CAUTION</b>
	This equipment is designed and sold for commercial use only. This equipment is not to be used by the consumer in home use. Do not allow direct contact of this equipment by the public when used in food service locations. Only personnel trained and experienced in the equipment operation may operate this equipment. Carefully read all installation instructions before operating the equipment.

	<b>⚠ WARNING</b>
	Always wear safety glasses when servicing this equipment.

	<b>⚠ WARNING</b>
	Any alterations to this equipment will void the warranty and may cause a dangerous situation. NEVER make alterations to the equipment.

	<b>⚠ DANGER</b>
	Machine must be properly grounded to prevent electrical shock to personnel. Do NOT immerse the equipment in water. Always unplug the equipment before cleaning or servicing.

## NOTE

The information, specifications and illustrations contained in this manual represent the latest data available at time of publication. Right is reserved to make changes as required at the discretion of Gold Medal Products Company without notice.

## INSTALLATION

### CHECKING SHIPMENT

Your new Accu-Meter Oil Pump is completely assembled and ready to operate. Remove the corrugated carton from the machine. Check thoroughly for any damage which may have occurred in transit. Damage claims should be filed immediately with the transportation company.

### ELECTRICAL REQUIREMENTS

Standard units operate on 120 Volt, 60 Hertz, 7.05 Amps.

	<b>⚠ DANGER</b>
	Machine must be properly grounded to prevent shock in case of electrical problems.

### FINAL PREPARATIONS

Your new Accu-Meter Oil Pump was adjusted, inspected and tested before it left the factory, and is ready to operate with some fine adjustment to the volume of oil delivered to your popper (see adjustment instructions on the following page). **NOTE:** We recommend premelting oil in the bucket with Gold Medal's HOT WAND, catalog #2018, before inserting your new bucket pump to prevent the possibility of damage to the heat element.

### INSTALLATION

1. Place your oil pump in a premelted bucket of oil.
2. Connect the plastic oil delivery tube (located in your popper) to the quick disconnect (located on your oil pump) using the hose clamp supplied with your popcorn machine.
3. Connect the power supply cord (located under your popper) to the disconnect plug on your oil pump. **NOTE:** Volume measurements should be taken from the oil delivery tube located in your existing popper above the kettle.

## OPERATING INSTUCTIONS

### HIGH HEAT

1. Turn on the "OIL SYSTEM MASTER SWITCH" located on the switch panel in your popper.
2. The High Heat Cycle is factory set at 30 minutes.
3. If desired, reset the High Heat Timer to your desired cycle time by turning the control with a small screwdriver.
4. To start the High Heat Cycle, press the "HEAT" button.

### PUMP CYCLE

1. The oil quantity is factory set at approximately 8 ounces (237 ml). You will need to set the volume of oil to your corn charge.
2. With a measuring cup under the tube in the ceiling of the popper over the kettle, set the quantity to your desired ratio (30%). See chart below.
3. Allow oil to drain completely before rechecking oil quantity.

Raw Corn Charge	Oil Charge
12 Oz. (355 ml)	3½ Oz. (103 ml)
14 Oz. (414 ml)	4¼ Oz. (126 ml)
16 Oz. (473 ml)	4¾ Oz. (140 ml)
20 Oz. (591 ml)	6 Oz. (177 ml)
28 Oz. (828 ml)	8½ Oz. (251 ml)
32 Oz. (946 ml)	9½ Oz. (281 ml)
36 Oz. (1065 ml)	10¾ Oz. (318 ml)

## MAINTENANCE INSTRUCTIONS

	<b>⚠ CAUTION</b>
	<p>THE FOLLOWING SECTIONS OF THIS MANUAL ARE INTENDED ONLY FOR QUALIFIED SERVICE PERSONNEL WHO ARE FAMILIAR WITH ELECTRICAL EQUIPMENT. THESE ARE NOT INTENDED FOR THE OPERATOR.</p>

	<b>⚠ WARNING</b>
	<p>Adequate eye protection must be used when servicing this equipment to prevent the possibility of injury.</p>

	<b>⚠ DANGER</b>
	<p>Do NOT immerse the equipment in water. Unplug your machine before servicing.</p>

## ORDERING SPARE PARTS

1. Identify the desired part by checking it against the photos, illustrations, and/or the parts list.
2. When ordering, please include part number, part name, and quantity desired.
3. Please include your model name and machine serial number (located on the machine nameplate) with your order.
4. Address all parts orders to:

Jarco Industries

order toll free 800-458-7578

or order online at [www.concessionstands.com](http://www.concessionstands.com)

# BUCKET SEASONING PUMP ASSEMBLY

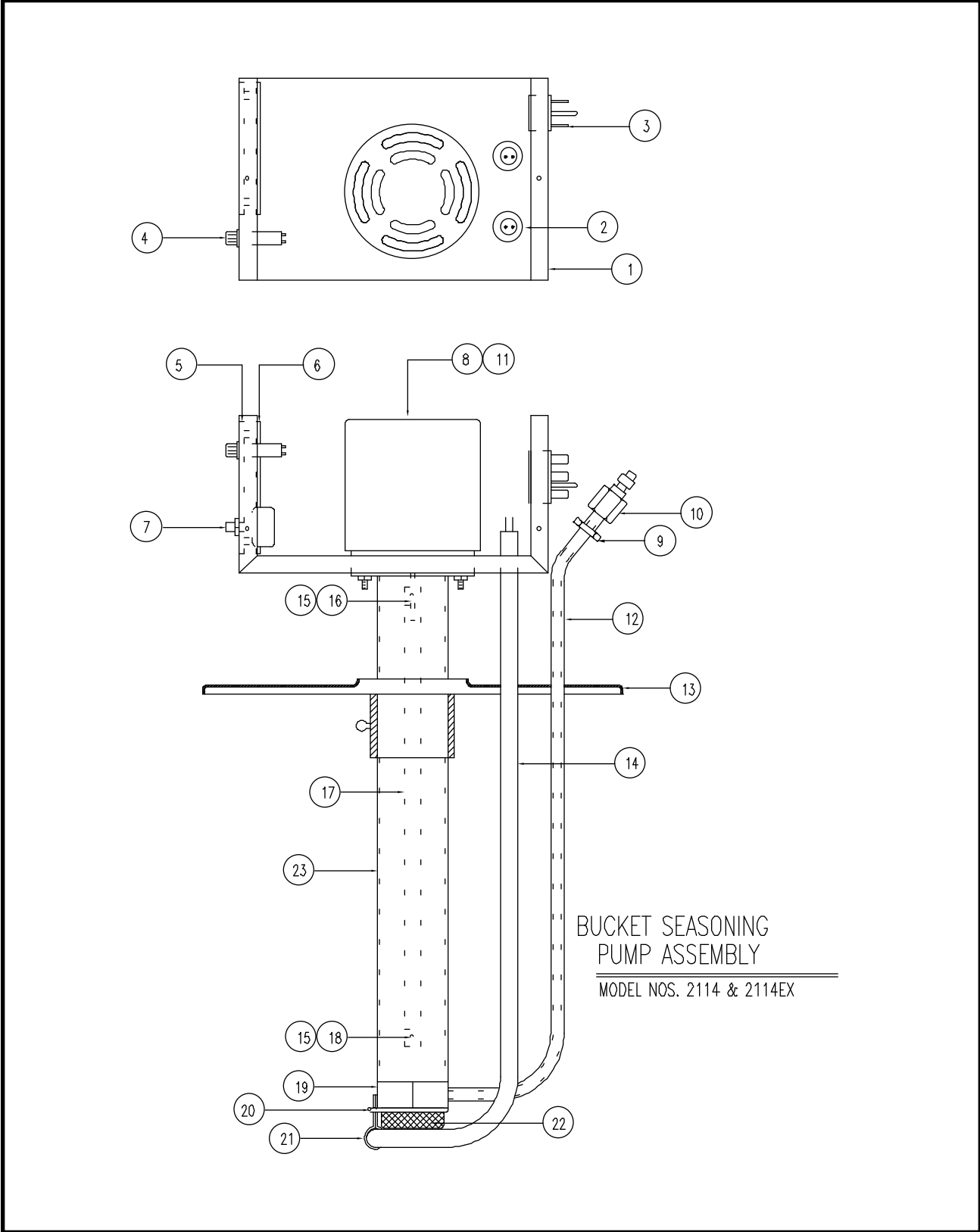

## PARTS LIST – BUCKET SEASONING PUMP ASSEMBLY

Item No.	Part No.	Description
1	79063	Junction Box
	79062	Junction Box Cover
2	79075	Mounting Clip
3	79004	Disconnect Plug
4	41033	Pilot Light
5	79086	Heat Sink Assembly
6	79078	Dual Timer Bucket Pump
7	41031	Switch, Oil Pump
8	79077	Pump Motor
9	79022	Pipe Reducer
10	79008	Quick Disconnect Coupling
11	79005	Pump Motor Gasket
12	79015	Oil Delivery Tube
13	79030	Bucket Pump Lid Assembly
14	79002	Heat Element
15	10094	Spring, U-Clip
16	79019	Drive Shaft Bushing (Motor End)
17	79011	Drive Shaft
18	79020	Drive Shaft Bushing (Pump End)
19	79001	Pump Assembly
20	79018	Clamp, Filter Screen
21	79017	Element Retainer
22	79016	Filter Screen
23	79023	Pump Mounting Tube



# ELECTRICAL SCHEMATIC

