

# FILM-TECH

**THE INFORMATION CONTAINED IN THIS ADOBE ACROBAT PDF FILE IS PROVIDED AT YOUR OWN RISK AND GOOD JUDGMENT.**

**THESE MANUALS ARE DESIGNED TO FACILITATE THE EXCHANGE OF INFORMATION RELATED TO CINEMA PROJECTION AND FILM HANDLING, WITH NO WARRANTIES NOR OBLIGATIONS FROM THE AUTHORS, FOR QUALIFIED FIELD SERVICE ENGINEERS.**

**IF YOU ARE NOT A QUALIFIED TECHNICIAN, PLEASE MAKE NO ADJUSTMENTS TO ANYTHING YOU MAY READ ABOUT IN THESE ADOBE MANUAL DOWNLOADS.**

**[WWW.FILM-TECH.COM](http://WWW.FILM-TECH.COM)**

**BROWNIE 8**

***MOVIE PROJECTOR***



**MODEL A15G**



## connection to the electricity supply

---

The projector must be connected only to a 50-cycle a.c. electricity supply in the range 200-250 volts.

Before use, the projector must be adjusted to suit the voltage of the electricity supply in your area. Owing to variations in the electrical fittings in use today no plug is supplied for the mains lead of the projector. It is therefore necessary to fit a suitable plug and adjust the equipment to the voltage range in your district.

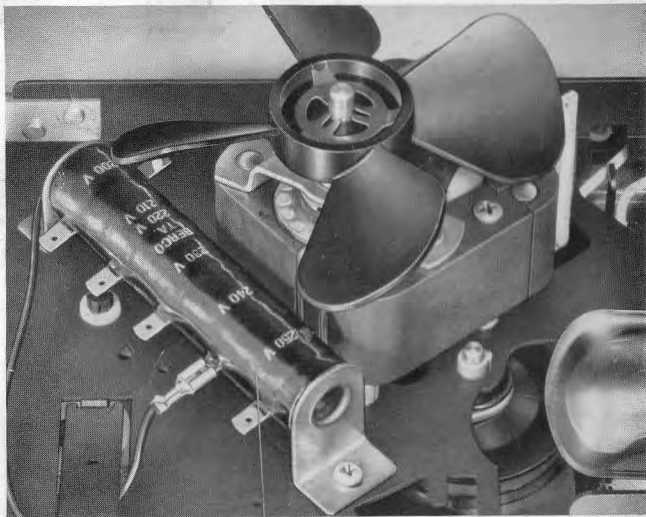

figure 1

RESISTOR

To gain access to the voltage adjuster, release the CAPTIVE SCREW (figure 2) and gently allow the mechanism plate to hinge forward. The interior is shown in figure 1. A RESISTOR is shown with a range of tappings from 200 to 250 volts marked in 10 volt steps. Push the brass terminal at the end of the lead on to the tag appropriate to the mains voltage in your locality.

Close the projector and fasten with the captive screw. Take the three-core mains lead from the compartment at the base of the projector, and fit a plug of suitable type. The projector takes no more than 2 amp; if a fused plug is used it should be fitted with a 2-amp fuse.

The 9 ft length of 3-core flexible cable embodies red and black supply leads, and a third lead which is marked EARTH. Connect the RED lead to the LIVE line and the BLACK lead to the NEUTRAL line. The third lead, which is marked EARTH, should then be connected to the earthed point. NEVER connect the earth lead to either of the supply terminals.

*If in doubt, consult an electrician.*

## setting up

---

The room should be dark enough for a brilliant image to be seen on the screen. However, some light may be desirable, provided that it does not shine on the screen or into the eyes of the audience.

Proceed as follows:

1. Place the projector on a firm support of convenient height, at the distance to suit the screen size suggested in the following table.

### RECOMMENDED PROJECTION DISTANCES AND SCREEN SIZES

Screen Size	Projection Distance
18" × 24"	8½ feet
23" × 30"	11 feet
30" × 40"	14½ feet
36" × 48"	17½ feet

2. Plug into the mains supply socket (a.c. only).
3. Start the motor and switch on the projector lamp by turning the CONTROL SWITCH\* fully to 'PROJECT'.

\* The control switch knob is made readily removable for servicing purposes. If it should work loose during normal use, it only requires to be pushed back firmly into position.

4. Centre the lighted area vertically on the screen by turning the ELEVATING KNOB; centre it horizontally by moving the projector gently sideways. Move the FOCUSING LEVER up or down until the margins of the lighted area on the screen are sharp.
5. Turn the control switch to 'OFF'.

## threading

The automatic threading and take-up mechanism works best when 'Kodak' White Movie Leader is spliced to the film. Films processed by Kodak are returned to you with white leader attached. If you have films with black leader, splice on at least one foot of white leader (available from your Kodak dealer) so that it curls towards the centre of the full reel.



figure 2

figure 3

FILM CUTTER

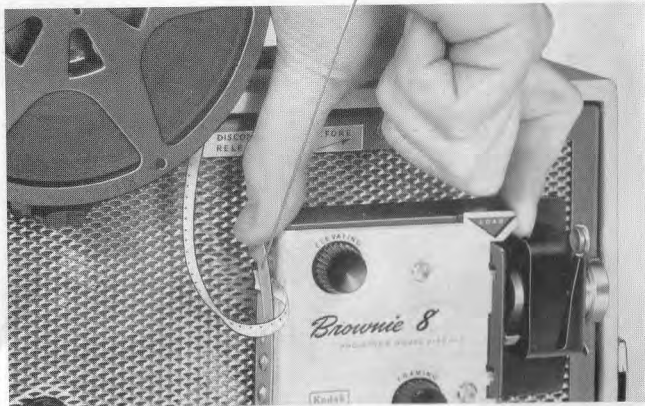

Threading procedure is as follows:

1. Swing the upper reel arm clockwise to the upright position. Place a reel of 8 mm film (200 foot maximum) on the upper spindle so that the film draws from the top with the perforated edge towards you. Be sure that the reel is held on by the raised lip at the tip of the spindle, and that the leader has a slight but not excessive curl tending to wrap itself on the spool.
2. Cut the end of the leader square by means of the FILM CUTTER. Place the end of the leader under the cutter and press the spring blade as shown in figure 3.
3. Fit an empty 200 ft take-up reel to the lower spindle, making sure that the teeth of the plastic take-up clutch fitted to the core are on the edge nearer to you, on the outside.
4. Turn the CONTROL SWITCH fully to 'PROJECT'.
5. Feed the leader into the film channel in front of the SNUBBER until the perforations are engaged by the claw mechanism (figure 4). The film will now be transported by

the automatic threading mechanism and will be guided on to the toothed core of the take-up reel, where it will attach itself for take-up.

#### Alternative threading procedure:

If you *have* to use black leader, follow points 1, 2 and 3 then:

4. Feed leader into the film channel until it either appears at the lower end of the channel or meets resistance after about  $1\frac{1}{2}$  inches have entered.
5. Turn the CONTROL SWITCH fully to 'PROJECT'. It may be necessary to guide black leader on to the take-up spool by hand.

If the mechanism fails to transport the film, switch off and re-insert the film.

*NOTE: If the motor of your projector fails to run, check the lamp. The motor will not function if the lamp is faulty, or if it has been removed.*

## projection

1. With the projector running, move the FOCUSING LEVER up or down until the pictures on the screen are sharp and clear.
2. If a black strip or the edge of the next picture shows at the top or bottom of the screen image, turn the FRAMING KNOB until the picture is properly framed.
3. When you have finished projecting, turn the control switch fully to 'OFF'.

## operating hints

1. If the picture on the screen is upside down and the action is backwards, the film has not been rewind.

2. If the film breaks, turn off the projector. After unthreading the projector, splice the film; then rewind the film to the upper reel (as described below) and re-thread the projector.
3. Do not turn the control switch to 'REWIND' while the reels are set up for projection otherwise film will be spilled.
4. For viewing by one or two people, or for editing, the side cover of the projector case may be used as a small projection screen.
5. From time to time, examine your films for physical damage. Torn perforations can lead to poor operation of the projector. Cut them out and splice the film.



figure 4

FRAMING KNOB

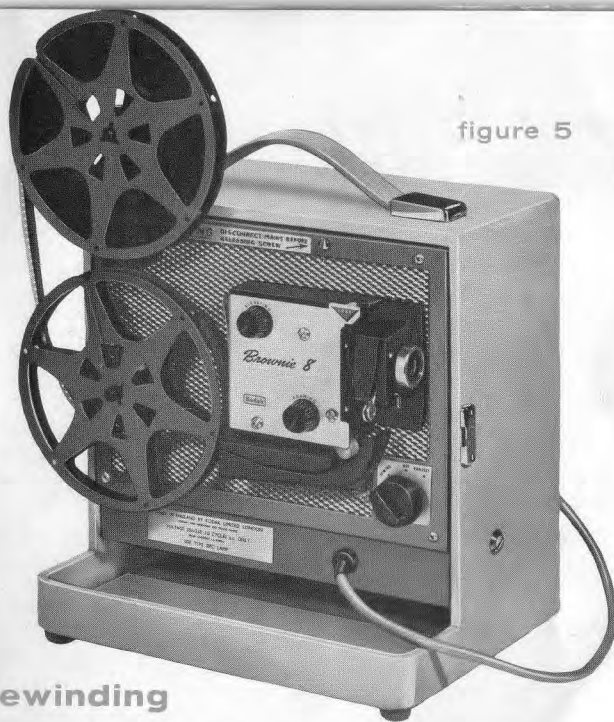

figure 5

## rewinding

To rewind the film, interchange the reels so that the full reel of film is on the upper (supply) spindle and the empty reel is on the lower (take-up) spindle. Now attach the film to the lower reel and turn the control switch fully to 'REWIND', as shown in figure 5. After the film is completely rewound, turn the control switch fully to 'OFF'. Remember that the empty reel now on the top spindle is the special 'automatic take-up' type: retain it for that purpose.



## after the show

1. Remove the reels from the spindles. Swing the upper reel arm counter-clockwise to the 'down' position.
2. Unplug the mains lead, coil it, and return it to the compartment at the base of the projector.

## care of the projector

*NOTE: Make sure that the mains lead is disconnected from the mains socket before opening the projector, and during any adjustments to the interior.*

**LAMP REPLACEMENT:** The lamp is a Sylvania 'Tru-Focus', Code DFC. If the projector is threaded, remove the pressure pad (see next paragraph) and ease film out of the gate; remove the spools. Then release the captive screw and swing the mechanism plate

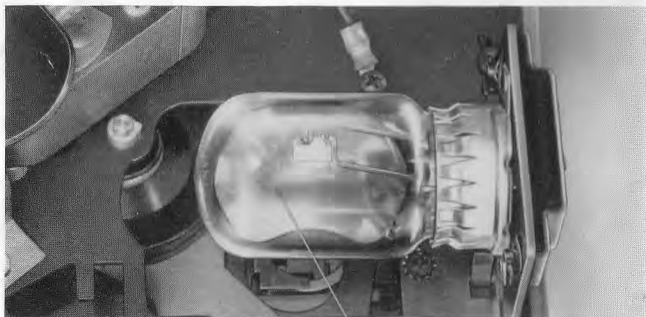
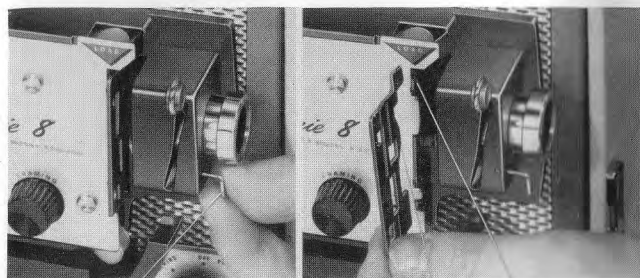

figure 6

LAMP

figures 7 and 8



**SPRING LATCH**

**PRESSURE PAD**

**APERTURE PLATE**

forward. Allow the lamp to cool; remove it with a straight pull. See that the key on the centre post of the new lamp locates in the keyway of the socket, then push the lamp in until it 'clicks' home and is fully seated. Re-assemble the projector and rewind the film.

## cleaning film gate and aperture

To remove the film gate for cleaning, first raise the focusing lever as far as it will go. Then release the spring tension against the gate by pulling the **SPRING LATCH** (figure 7) forward and pushing it toward the back panel until it locks in the forward position. Move the **PRESSURE PAD** toward the lens, disengage it from the studs on the **APERTURE PLATE**, and carefully lift it out (see figure 8). With a soft, damp, lintless cloth, clean the pressure pad and film track. Remove any particles in the aperture. Often, blowing lightly will remove these particles. Take care not to bend the pressure pad.

Replace the pressure pad, engaging the studs on the aperture plate in the holes in the pad, and release the spring latch.

## cleaning the projection lens

If it is necessary to remove the projection lens for cleaning, raise the focusing lever as far as it will go. Release the spring tension against the gate by pulling the spring latch forward and pushing it toward the back panel until it locks in the forward position. Remove the pressure pad.

Slide the LENS MOUNT HOUSING toward the film channel until it is free to be removed (see figure 9).

With a soft, clean, lintless cloth carefully wipe the front and rear surfaces of the lens. Do not use a wet cloth; if moisture is required, breathe on the lens or use a drop of 'Kodak' Lens Cleaner. Replace

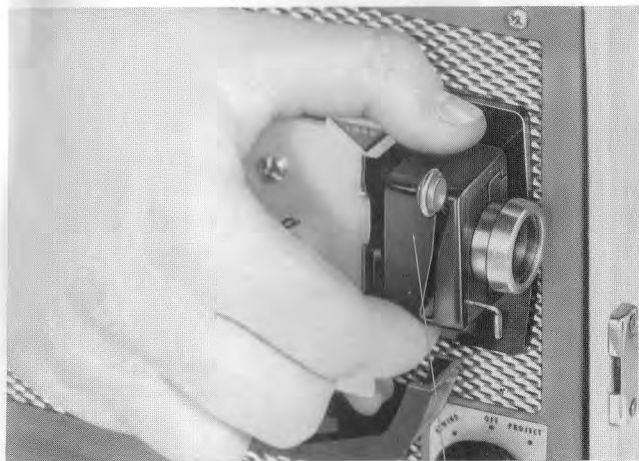

figure 9

LENS MOUNT HOUSING

the projection lens by inserting the lens mount housing in the retaining grooves and sliding the mount toward the back panel and then forward as far as it will go. Replace the pressure pad. Release the spring latch to apply pressure against the film gate.

## lubrication

All bearings are self-lubricating and require no oiling.

## auxiliary equipment

*200-foot 8mm 'Kodak' Movie Reel and Can.* Should be used together for safe storage of films.

*Take-up Reel Clutch.* This will convert a movie reel for automatic take-up. Simply fit a clutch to the core of the reel like a bicycle clip, making sure that the teeth are on the same side as the slot in the take-up spool.

*'Kodak' Movie Film Splicing Kit.* An inexpensive kit for simple splicing of leaders, etc.

*'Kodak' Prestape Movie Splicer.* New easy-to-use dry splicer using a pressure-sensitive adhesive tape to make splices.

Ask your Kodak dealer for further advice about these accessories, and for details of the range of 'Kodak' publications designed to help you to get more fun from photography.

Product names quoted thus - 'Kodak' - are trade marks

Printed in England

11/40/13 RL351163(147/r1)