

Film-Tech

The information contained in this Adobe Acrobat pdf file is provided at your own risk and good judgment.

These manuals are designed to facilitate the exchange of information related to cinema projection and film handling, with no warranties nor obligations from the authors, for qualified field service engineers.

If you are not a qualified technician, please make no adjustments to anything you may read about in these Adobe manual downloads.

www.film-tech.com

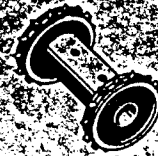
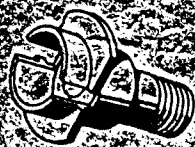
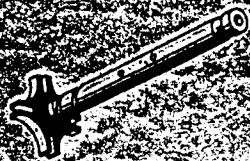
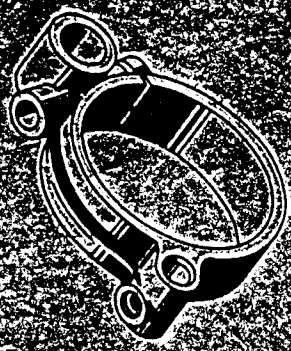

PARTS LIST

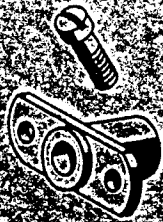
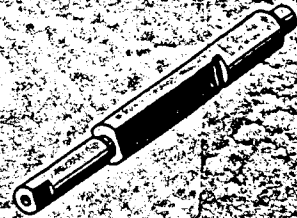

for the

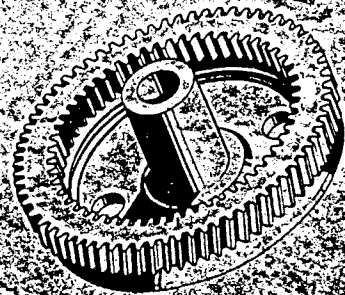

*Super
Simplex*

Copyright 1945
by
NATIONAL-SIMPLEX-BLUDWORTH, INC.

Make Parts-Ordering **AS SIMPLE AS A-B-C!**



IN PLANNING this book we had only *one* objective—to enable you to place your order for replacement parts quickly and accurately, avoiding the costly, time-consuming errors which often result in interrupted performance and lost revenue.

That is why we have spared no time, effort and expense in making this a book which will literally place the information you want right at your fingertips.

We have given particular attention to the illustrations and have used the modern art technique known as the “exploded view” in which each part may be clearly seen in relation to its associated units in each assembly.

We believe you will find that with this book as a guide, ordering Simplex parts becomes as simple as A-B-C—

A—*Locate the part you want on the illustration.*

B—*Jot down the part number.*

C—*Place your order with your nearest NATIONAL branch.*

USE ONLY **GENUINE** *Simplex* PARTS

*Safeguard your
most Valuable Assets*

GOOD PROJECTION • PLEASSED PATRONS
with Genuine
SIMPLEX PARTS

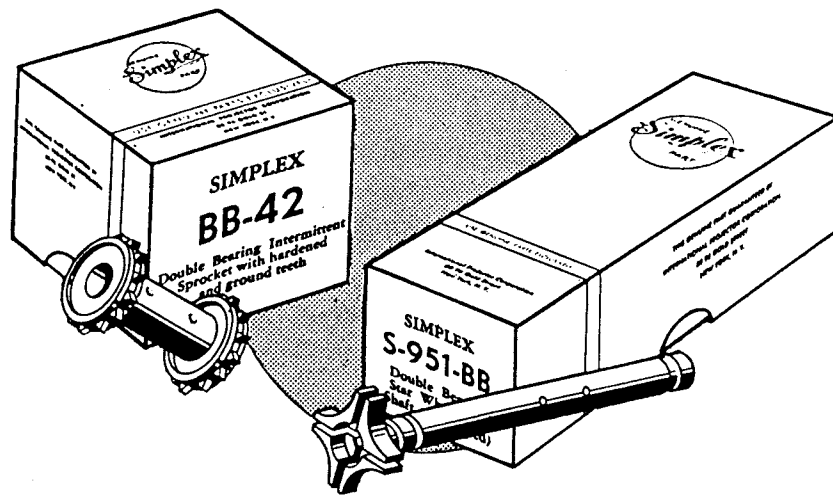

Join the ranks of SIMPLEX Owners for they are the ones that lead all others in loyalty to the Projectors and Parts they are using today. Men who have seen them at work for well over three decades—men who have put their trust in them and found their confidence justified—they are the men that proudly tell others about the extraordinary performance and rugged dependability of Simplex Projectors and Simplex Parts.

And when replacement parts are necessary, demand and use only Genuine Simplex Parts—packed in the distinctive yellow and black box—your guarantee of Better Projection.

BETTER PROJECTION PAYS

TABLE OF CONTENTS

Automatic Fire Shutter Device.....	11
Doors and Covers.....	46-47
Film Trap.....	14-15
Film Trap Door.....	12-13
Film Trap Door Holder and Lock.....	45
Front Shutter Attachment.....	42-44
Intermediate Gear and Associated Parts.....	16-19
Intermittent Movement.....	8-10
Lens Holder.....	48-49
Lower Sprocket and Associated Parts.....	28-29
Main Drive Shaft and Gear.....	11
Main Frame - Film Side.....	38-39
Main Frame - Gear Side.....	40-41
Rear Shutter and Associated Parts.....	30-32
Shutter Adjusting and Framing Devices.....	33
Shutter Gear Bracket.....	22-25
Spot Sight Box and Mount.....	36-37
Threading Lamp.....	34-35
Upper Sprocket and Associated Parts.....	26-27
Vertical Shaft and Associated Parts.....	20-21
Price List.....	50-53

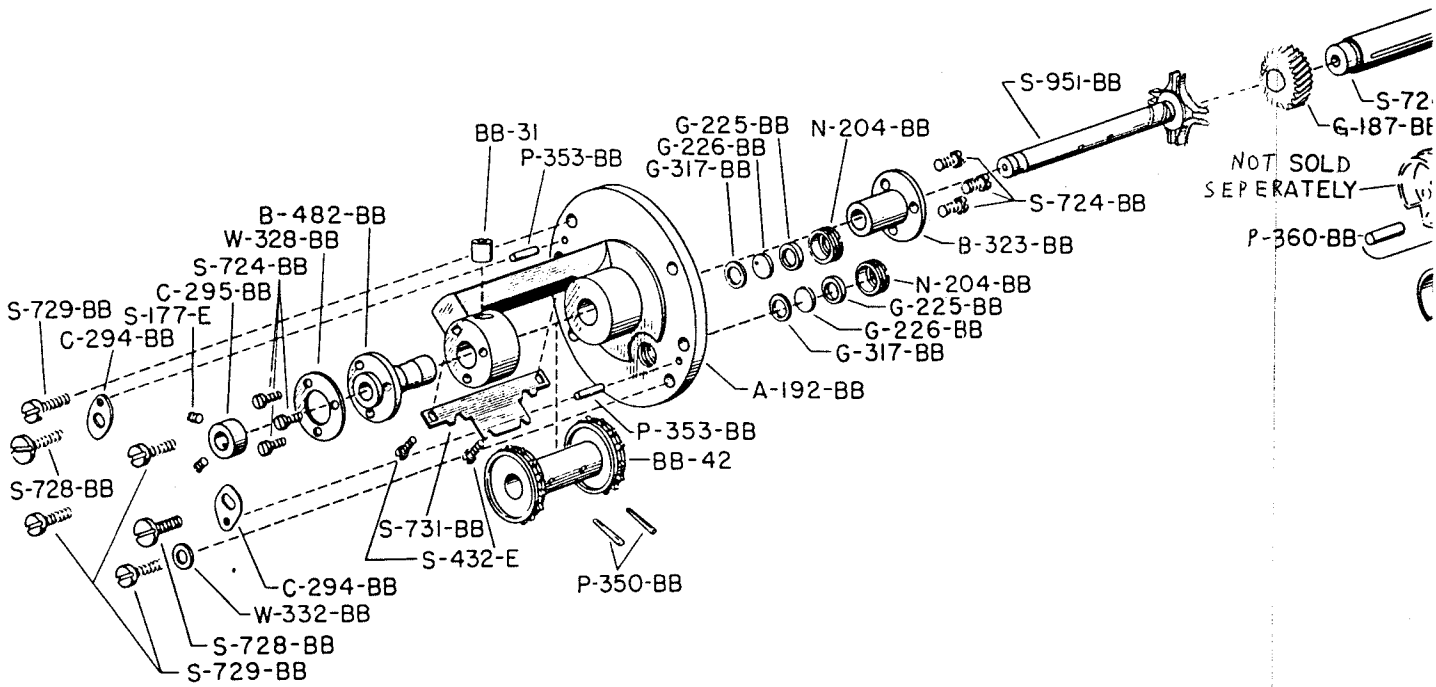

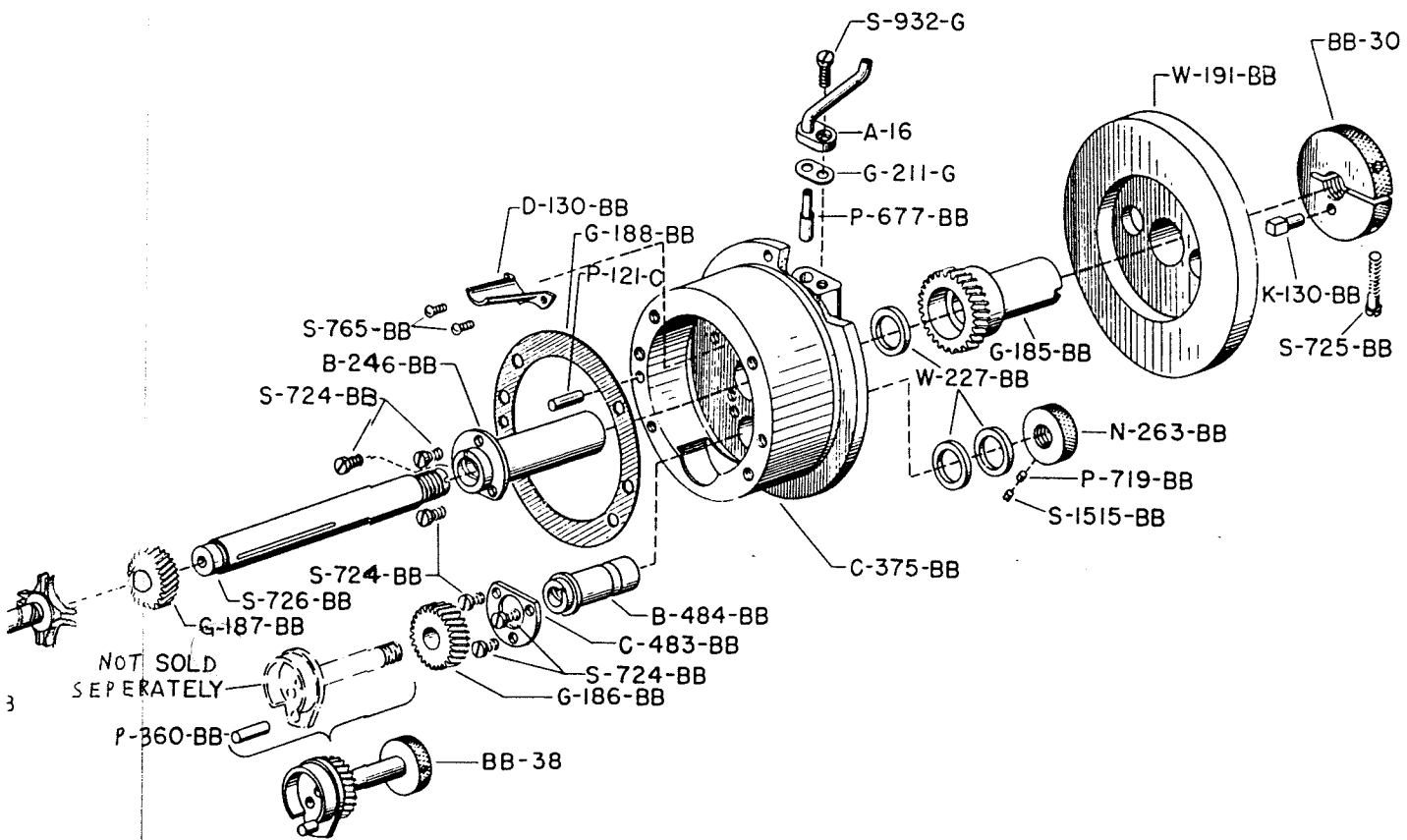

MITTENT MOVEMENT

6-7-8

INTERMITTENT MOVEMENT

BBB INTERMITTENT MOVEMENT COMPLETE

ASSEMBLIES

- BB-27 FLYWHEEL GEAR AND SHAFT ASSEMBLY
G-187-BB S-726-BB
- BB-28 FLYWHEEL AND GEAR ASSEMBLY
G-185-BB W-191-BB
- BB-30 FLYWHEEL LOCKNUT AND KEY ASSEMBLY
K-130-BB S-725-BB
- BB-38 INTERMITTENT CAM ASSEMBLY
BB-56 G-186-BB P-360-BB
- BB-40 INTERMITTENT CASE COVER AND ARM ASSEMBLY
A-192-BB G-225-BB (2) G-317-BB (2) P-353-BB (2)
BB-31 G-226-BB (2) N-204-BB (2)
- BB-52 INTERMITTENT CASE COVER AND BEARING ASSEMBLY
A-192-BB C-295-BB N-204-BB (2) S-724-BB (6)
B-323-BB G-225-BB (2) P-353-BB (2) S-731-BB
B-482-BB G-226-BB (2) S-177-E W-328-BB
BB-31 G-317-BB (2) S-432-E (2)
- BB-56 CAM SHAFT ADJUSTING NUT ASSEMBLY (Included in BB-38)
N-263-BB P-719-BB S-1515-BB

PARTS

- A-16 Intermittent Case Oil Tube
A-192-BB Intermittent Case Cover and Arm
B-246-BB Flywheel Shaft Bearing
B-323-BB Starwheel Shaft Inner Bearing
B-482-BB Starwheel Shaft Outer Bearing
B-484-BB Cam Shaft Bearing
BB-31 Outer Bearing Oil Cup
BB-42 Intermittent Sprocket (Includes 2 P-350-BB Pins)
C-294-BB Intermittent Case Cover Clamp (2)
C-295-BB Starwheel Shaft Collar
C-375-BB Intermittent Case
C-483-BB Cam Shaft Bearing Collar
D-130-BB Oil Deflector

BB47 INTERMITTENT SPROCKET USE LAVEZZI # 416 TL31B

INTERMITTENT MOVEMENT (continued)

G-185-BB	Flywheel Gear
G-186-BB	Intermittent Cam Gear
G-187-BB	Flywheel Shaft Gear
G-188-BB	Intermittent Case Cover Oil Gasket
G-211-G	Intermittent Oil Tube Gasket
G-225-BB	Oil Sight Glass Inner Gasket (2)
G-226-BB	Oil Sight Glass
G-317-BB	Oil Sight Glass Outer Gasket (2)
K-130-BB	Flywheel Lock Key
N-204-BB	Oil Sight Glass Nut (2)
N-263-BB	Cam Shaft Adjusting Nut
P-350-BB	Intermittent Sprocket Pin (2)
P-353-BB	Intermittent Case Retaining Clamp Pivot Pin (2)
P-360-BB	Intermittent Cam Pin
P-677-BB	Intermittent Case Oil Regulating Plug
P-719-BB	Cam Shaft Adjusting Plug
S-177-E	Starwheel Shaft Collar Set Screw (2)
S-432-E	Intermittent Sprocket Stripper Fastening Screw (2)
S-724-BB	Bearing Fastening Screw (12)
S-725-BB	Flywheel Lock Screw
S-726-BB	Flywheel Shaft
S-728-BB	Case Retaining Clamp Screw (2)
S-729-BB	Case Cover Screw (4)
S-731-BB	Intermittent Sprocket Stripper
S-765-BB	Oil Deflector Fastening Screw (2)
S-932-G	Intermittent Oil Tube Flange Fastening Screw
S-951-BB	Starwheel and Shaft (Hardened)
S-1515-BB	Cam Shaft Adjusting Nut Set Screw
W-191-BB	Flywheel
W-227-BB	Oil Retaining Washer (for B-246-BB (1) and B-484-BB (2)) (3)
W-322-BB	Oil Drain Screw Washer
W-328-BB	Starwheel Shaft Outer Bearing Washer

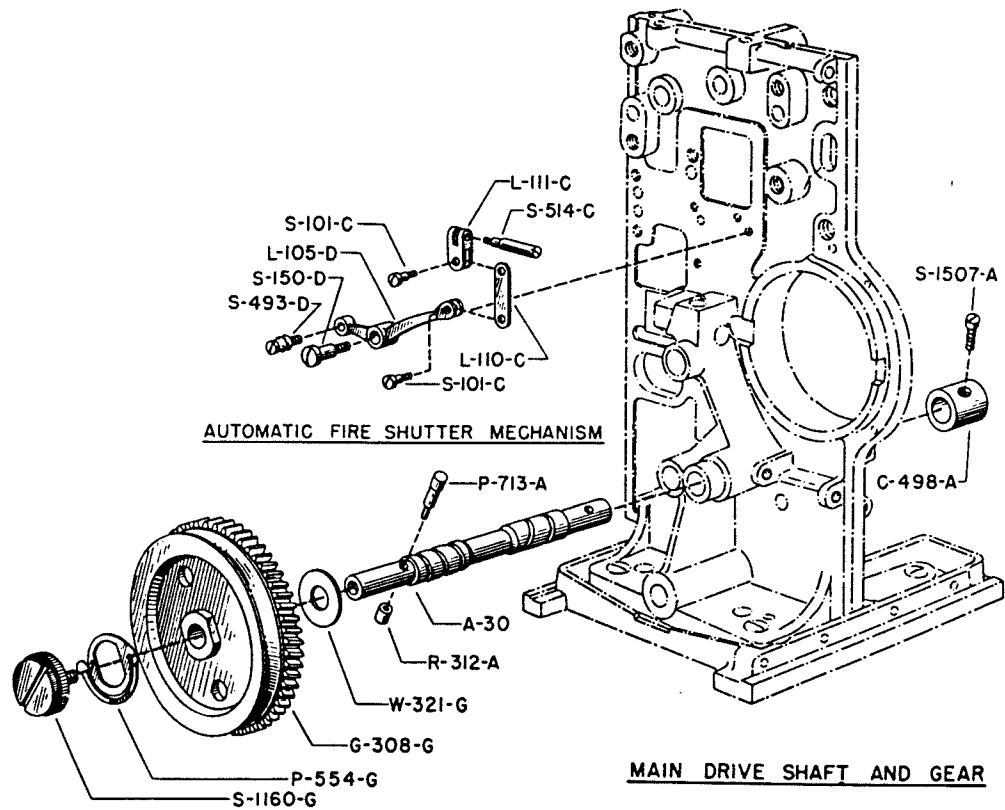

MAIN DRIVE SHAFT

ASSEMBLIES

A-30 MAIN DRIVE SHAFT ASSEMBLY

- | | |
|---------|-------------------------------|
| P-713-A | Main Drive Shaft Pin |
| R-312-A | Main Drive Shaft Pin Retainer |

PARTS

- | | |
|----------|---|
| C-498-A | Main Drive Shaft Collar |
| G-308-G | Main Drive Gear |
| P-554-G | Main Drive Gear Retaining Screw Spring Pawl |
| S-1160-G | Main Drive Gear Retaining Screw |
| S-1507-A | Main Drive Shaft Collar Screw |
| W-321-G | Main Drive Gear Washer |

AUTOMATIC FIRE SHUTTER DEVICE

PARTS

- | | |
|---------|--|
| L-105-D | Governor Lift Lever |
| L-110-C | Governor Lift Lever Link |
| L-111-C | Governor Lift Lever Connecting Link |
| S-101-C | Automatic Fire Shutter Link Hinge Spring (2) |
| S-150-D | Governor Lift Lever Pivot Screw |
| S-493-D | Governor Lift Lever Screw |
| S-514-C | Fire Shutter Lifting Stud |

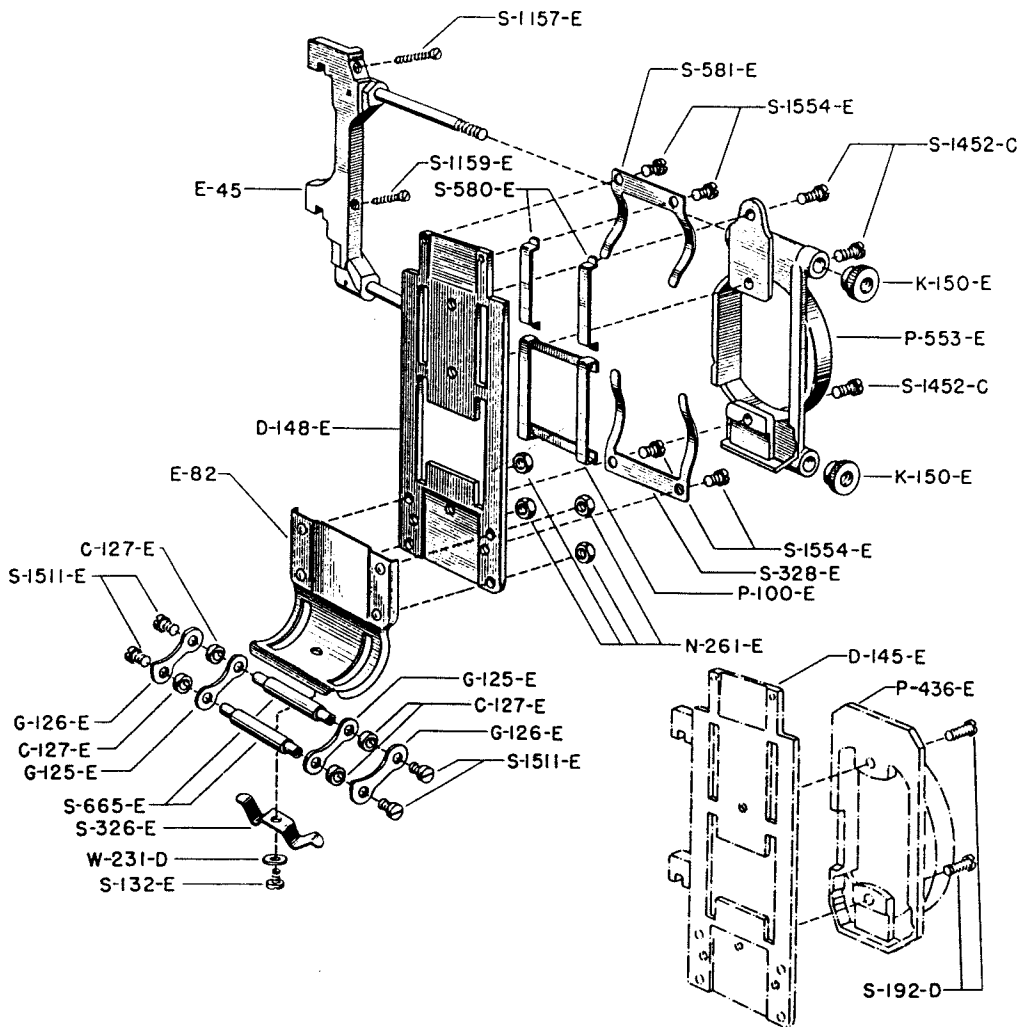

FILM TRAP DOOR

FILM TRAP DOOR

E-48 REMOVABLE FILM TRAP DOOR AND BRACKET COMPLETE

ASSEMBLIES

- E-3 INTERMITTENT FILM GUIDE ASSEMBLY
C-127-E (4) G-126-E (2) S-665-E (2) S-1511-E (4)
G-125-E (2)
- E-45 REMOVABLE DOOR LOCATING BRACKET AND STUDS ASSEMBLY
S-1157-E S-1159-E
- E-82 INTERMITTENT FILM GUIDE HOLDER ASSEMBLY
N-261-E (4)

PARTS

- C-127-E Intermittent Film Guide Spacer Collar (4)
D-148-E Removable Film Trap Door
G-125-E Intermittent Film Guide (Inside) (2)
G-126-E Intermittent Film Guide (Outside) (2)
K-150-E Removable Door Clamping Knob (2)
N-261-E Intermittent Film Guide Holder Stud Nut (4)
P-100-E Removable Door Pad
P-553-E Removable Door Protector
S-132-E Intermittent Film Guide Assembly Retaining Screw
S-326-E Intermittent Film Guide Tension Spring
S-328-E Removable Door Pad Spring
S-580-E Removable Door Double Tension Shoe (2)
S-581-E Removable Door Double Tension Shoe Spring
S-665-E Intermittent Film Guide Stud (2)
S-1157-E Removable Door Locating Bracket Fastening
Screw (Upper)
S-1159-E Removable Door Locating Bracket Fastening
Screw (Lower)
S-1452-C Removable Door Protector Fastening Screw (3)
S-1511-E Intermittent Film Guide Fastening Screw (4)
S-1554-E Fastening Screw (for S-328-E and S-581-E) (4)
W-231-D Intermittent Film Guide Assembly Retaining
Screw Washer

OLD STYLE PARTS STILL AVAILABLE

- D-145-E Film Trap Door
P-436-E Film Trap Door Protector
S-192-E Film Trap Door Protector Fastening Screw (2)

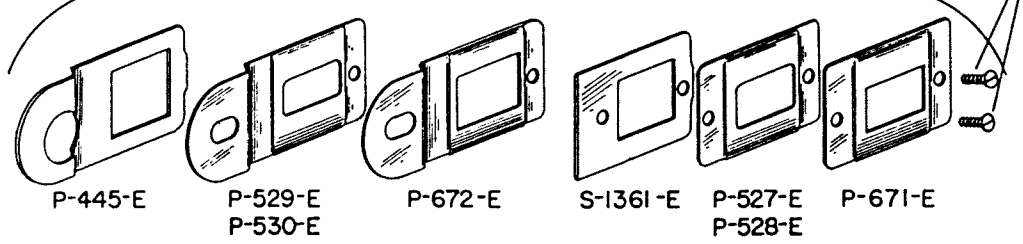
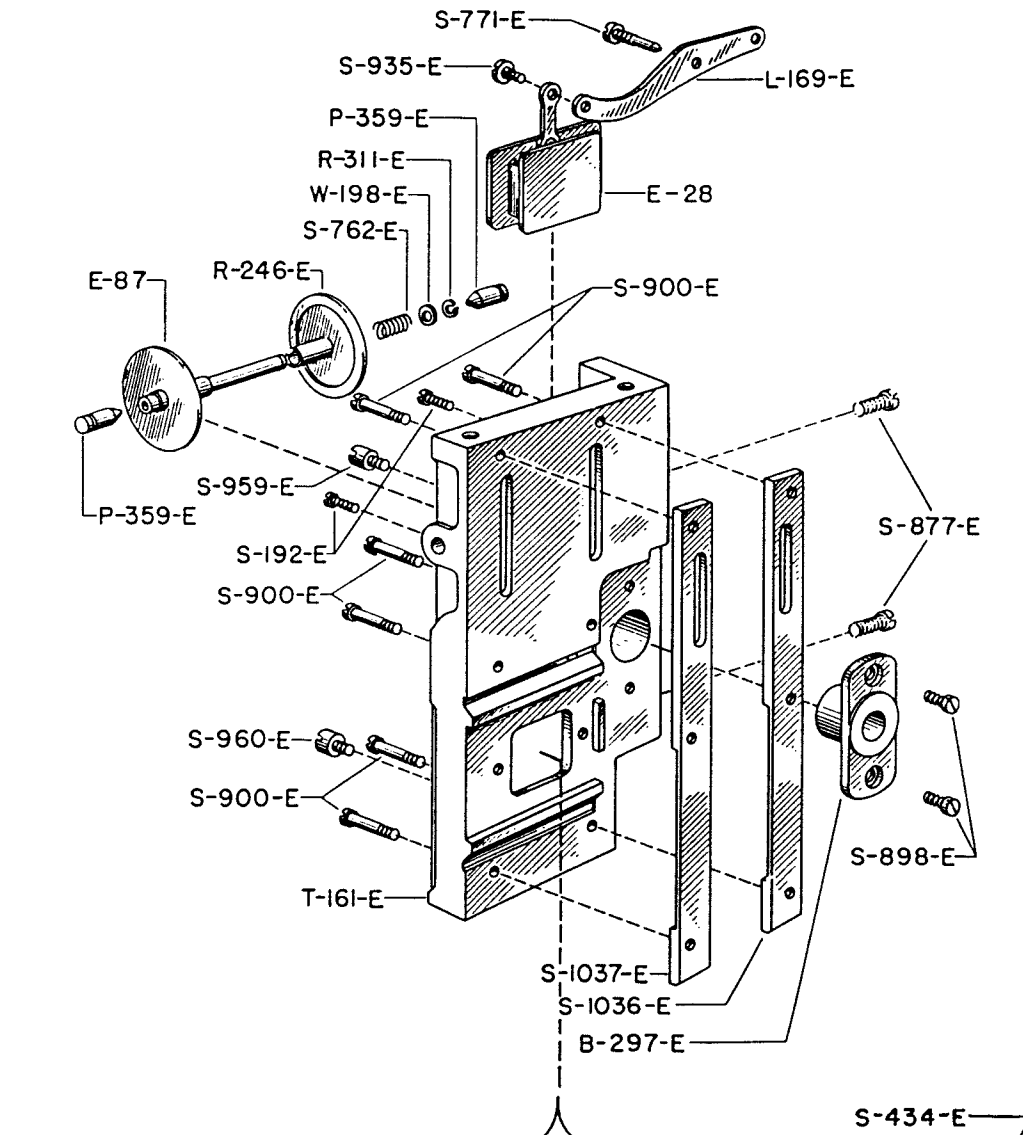

SLIP-IN TYPE

FIXED TYPE

APERTURE PLATES

FILM TRAP

FILM TRAP

E-95 FILM TRAP COMPLETE (Less Aperture Plate)

ASSEMBLIES

E-30 LATERAL GUIDE ROLLER AND SHAFT ASSEMBLY
E-87 R-311-E S-762-E W-198-E
R-246-E

PARTS

B-297-E Film Trap Bushing
E-28 Automatic Fire Shutter
E-87 Lateral Guide Roller and Shaft
L-169-E Automatic Fire Shutter Lift Lever
P-359-E Lateral Guide Roller Pivot (2)
R-246-E Lateral Guide Roller
R-311-E Lateral Guide Roller Washer Retainer
S-192-E Lateral Guide Roller Pivot Retaining Screw (2)
S-762-E Lateral Guide Roller Spring
S-771-E Automatic Fire Shutter Lift Lever Pivot Screw
S-898-E Film Trap Bushing Fastening Screw (2)
S-900-E Film Trap Shoe Fastening Screw (6)
S-935-E Automatic Fire Shutter Link Connecting Screw
S-959-E Automatic Fire Shutter Upper Stop Screw
S-960-E Automatic Fire Shutter Lower Stop Screw
S-1036-E Film Trap Shoe (Inside)
S-1037-E Film Trap Shoe (Outside)
T-161-E Film Trap
W-198-E Lateral Guide Roller Spring Retainer Washer

APERTURE PLATES

FIXED TYPE

P-527-E Aperture Plate, Round Corners (.600" X .825")
P-528-E Aperture Plate, Round Corners (Undersize .600" X .800")
P-671-E Aperture Plate, Square Corners (.600" X .825")
S-434-E Aperture Plate Fastening Screw (2)
S-1361-E Aperture Spacing Plate

SLIP-IN TYPE

P-445-E Aperture Plate Sliding Piece
P-529-E Aperture Plate, Round Corners (.600" X .825")
P-530-E Aperture Plate, Round Corners (Undersize .600" X .800")
P-672-E Aperture Plate, Square Corners (.600" X .825")

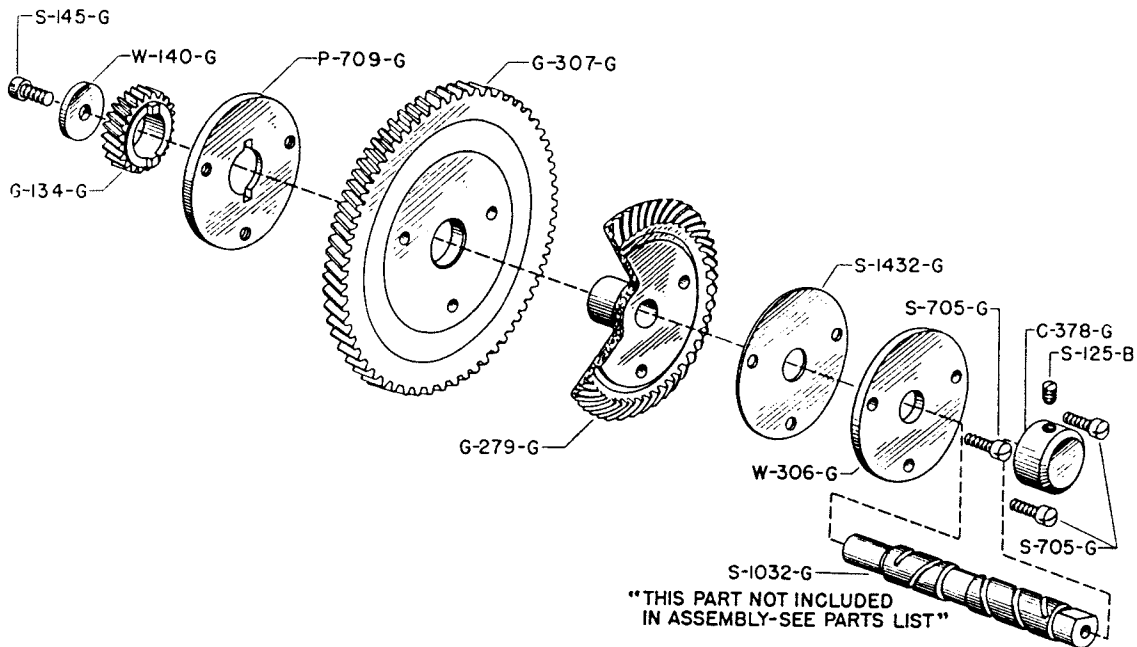

INTERMEDIATE GEAR AND ASSOCIATED PARTS
(SHOCKPROOF TYPE WITH SPIRAL BEVEL GEAR)

GG-5 SPIRAL BEVEL SHOCKPROOF INTERMEDIATE GEAR KIT COMPLETE

ASSEMBLIES

G-92 SHOCKPROOF INTERMEDIATE GEAR AND PLATE ASSEMBLY
G-307-G P-709-G S-705-G (3)

PARTS

C-378-G	Intermediate Shaft Retaining Collar
G-134-G	Intermediate Small Steel Gear
G-279-G	Intermediate Spiral Bevel Gear
G-307-G	Shockproof Intermediate Gear
P-709-G	Intermediate Gear Plate
S-125-B	Intermediate Shaft Collar Screw
S-145-G	Intermediate Gear Washer Retaining Screw
S-705-G	Intermediate Gear Screw (3)
S-1432-G	Shim (Used only when required)
W-140-G	Intermediate Gear Washer (Outside)
W-306-G	Intermediate Gear Washer (Inside)

PARTS ILLUSTRATED BUT NOT INCLUDED IN ABOVE ASSEMBLY

S-1032-G Intermediate Shaft

NOTE: The S-1032-G Intermediate Shaft is not included in the GG-5 Kit and must be ordered as a separate item. It is available in the Standard Diameter or in any of the following Oversizes: .001", .002", .003", .004" and .005". Specify the exact size desired. Otherwise the Standard Diameter will be furnished.

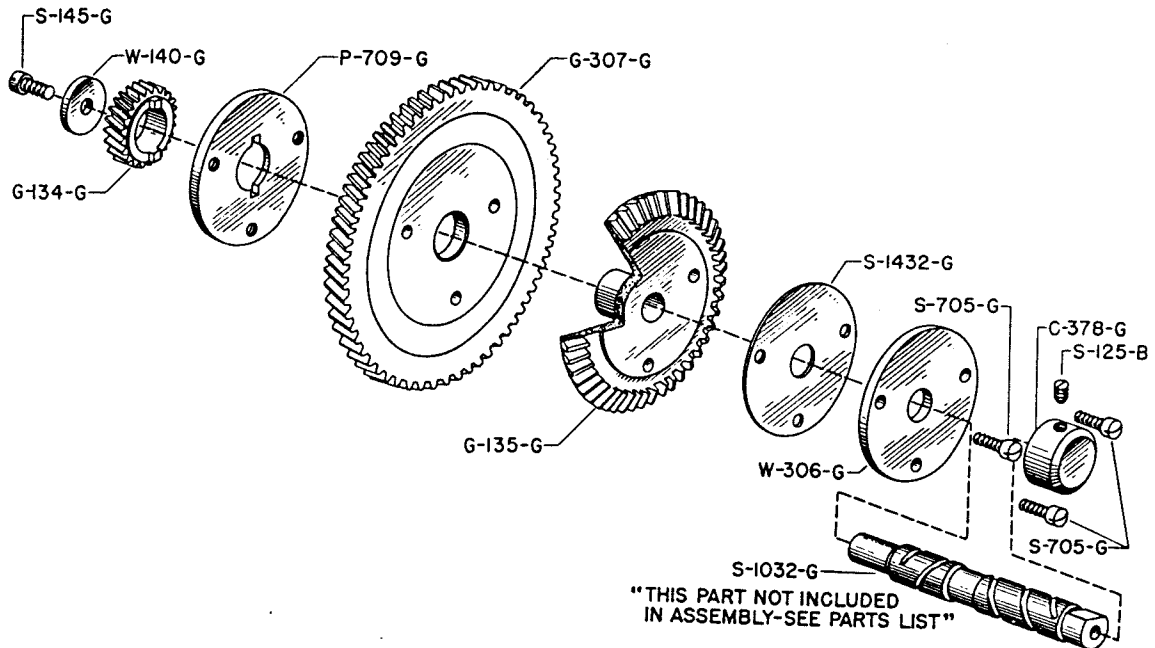

INTERMEDIATE GEAR AND ASSOCIATED PARTS

(SHOCKPROOF TYPE WITH STRAIGHT BEVEL GEAR)

GG-6 STRAIGHT BEVEL SHOCKPROOF INTERMEDIATE GEAR KIT COMPLETE

ASSEMBLIES

G-92 SHOCKPROOF INTERMEDIATE GEAR AND PLATE ASSEMBLY
 G-307-G P-709-G S-705-G (3)

PARTS

C-378-G	Intermediate Shaft Retaining Collar
G-134-G	Intermediate Small Steel Gear
G-135-G	Intermediate Straight Bevel Gear
G-307-G	Shockproof Intermediate Gear
P-709-G	Intermediate Gear Plate
S-125-B	Intermediate Shaft Collar Screw
S-145-G	Intermediate Gear Washer Retaining Screw
S-705-G	Intermediate Gear Screw (3)
S-1432-G	Shim (Used only when required)
W-140-G	Intermediate Gear Washer (Outside)
W-306-G	Intermediate Gear Washer (Inside)

PARTS ILLUSTRATED BUT NOT INCLUDED IN ABOVE ASSEMBLY

S-1032-G Intermediate Shaft

NOTE: The S-1032-G Intermediate Shaft is not included in the GG-6 Kit and must be ordered as a separate item. It is available in the Standard Diameter or in any of the following oversizes: .001", .002", .003", .004" and .005". Specify the exact size desired. Otherwise the Standard Diameter will be furnished.

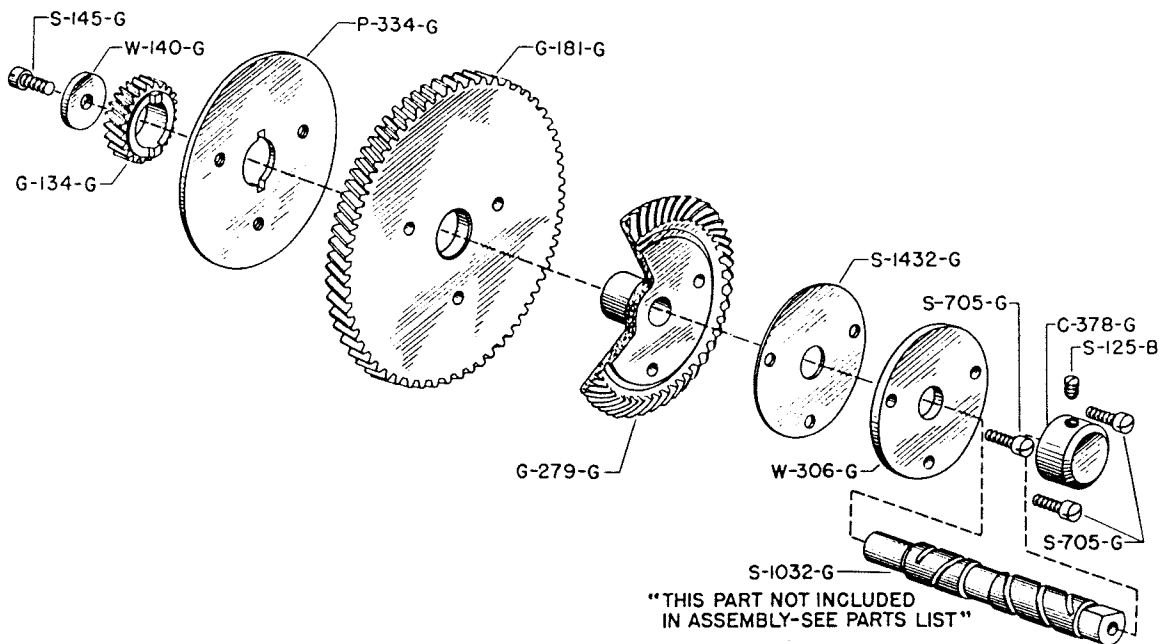

INTERMEDIATE GEAR AND ASSOCIATED PARTS

(FORMICA TYPE WITH SPIRAL BEVEL GEAR)

GG-9 FORMICA INTERMEDIATE GEAR KIT COMPLETE

ASSEMBLIES

G-12 FORMICA INTERMEDIATE GEAR AND PLATE ASSEMBLY
 G-181-G P-334-G S-705-G (3)

PARTS

C-378-G	Intermediate Shaft Retaining Collar
G-134-G	Intermediate Small Steel Gear
G-181-G	Formica Intermediate Gear
G-279-G	Intermediate Spiral Bevel Gear
P-334-G	Intermediate Gear Plate
S-125-B	Intermediate Shaft Collar Screw
S-145-G	Intermediate Gear Washer Retaining Screw
S-705-G	Intermediate Gear Screw (3)
S-1432-G	Shim (Used only when required)
W-140-G	Intermediate Gear Washer (Outside)
W-306-G	Intermediate Gear Washer (Inside)

PARTS ILLUSTRATED BUT NOT INCLUDED IN ABOVE ASSEMBLY

S-1032-G Intermediate Shaft

NOTE: The S-1032-G Intermediate Shaft is not included in the GG-9 Kit and must be ordered as a separate item. It is available in the Standard Diameter or in any of the following oversizes: .001", .002", .003", .004" and .005". Specify the exact size desired. Otherwise the Standard Diameter will be furnished.

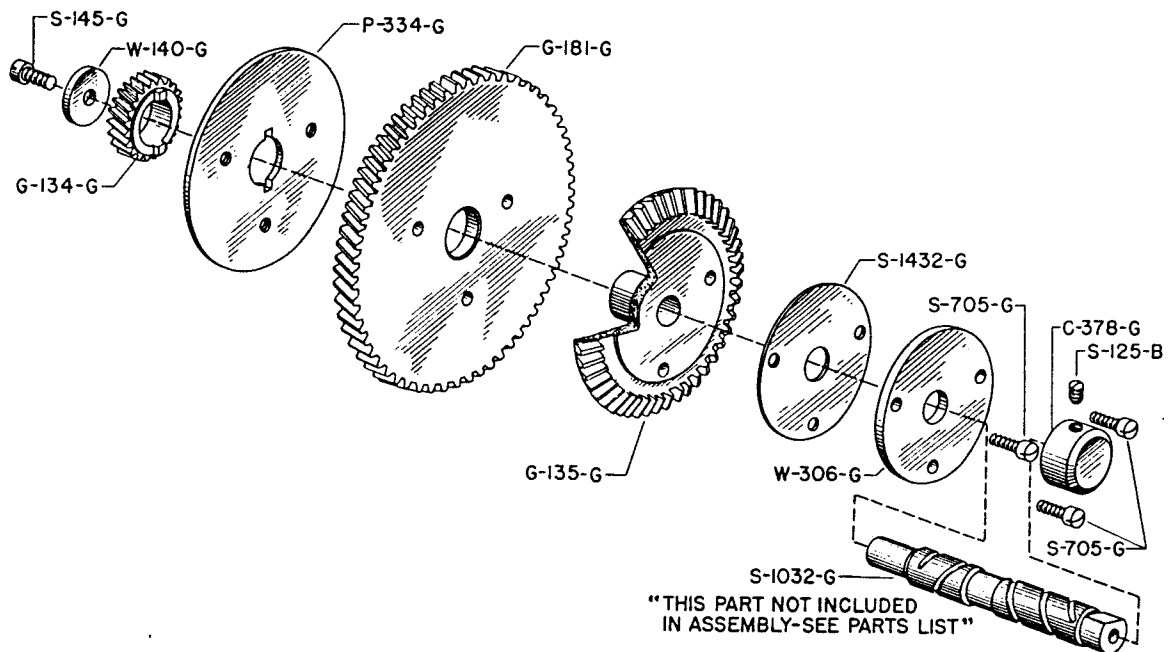

INTERMEDIATE GEAR AND ASSOCIATED PARTS

(FORMICA TYPE WITH STRAIGHT BEVEL GEAR)

GG-10 FORMICA INTERMEDIATE GEAR KIT COMPLETE

ASSEMBLIES

G-12 FORMICA INTERMEDIATE GEAR AND PLATE ASSEMBLY
 G-181-G P-334-G S-705-G (3)

PARTS

C-378-G	Intermediate Shaft Retaining Collar
G-134-G	Intermediate Small Steel Gear
G-135-G	Intermediate Straight Bevel Gear
G-181-G	Formica Intermediate Gear
P-334-G	Intermediate Gear Plate
S-125-B	Intermediate Shaft Collar Screw
S-145-G	Intermediate Gear Washer Retaining Screw
S-705-G	Intermediate Gear Screw (3)
S-1432-G	Shim (Used only when required)
W-140-G	Intermediate Gear Washer (Outside)
W-306-G	Intermediate Gear Washer (Inside)

PARTS ILLUSTRATED BUT NOT INCLUDED IN ABOVE ASSEMBLY

S-1032-G Intermediate Shaft

NOTE: The S-1032-G Intermediate Shaft is not included in the GG-10 kit and must be ordered as a separate item. It is available in the standard diameter or in any of the following oversizes: .001", .002", .003", .004" and .005". Specify the exact size desired. Otherwise the standard diameter will be furnished.

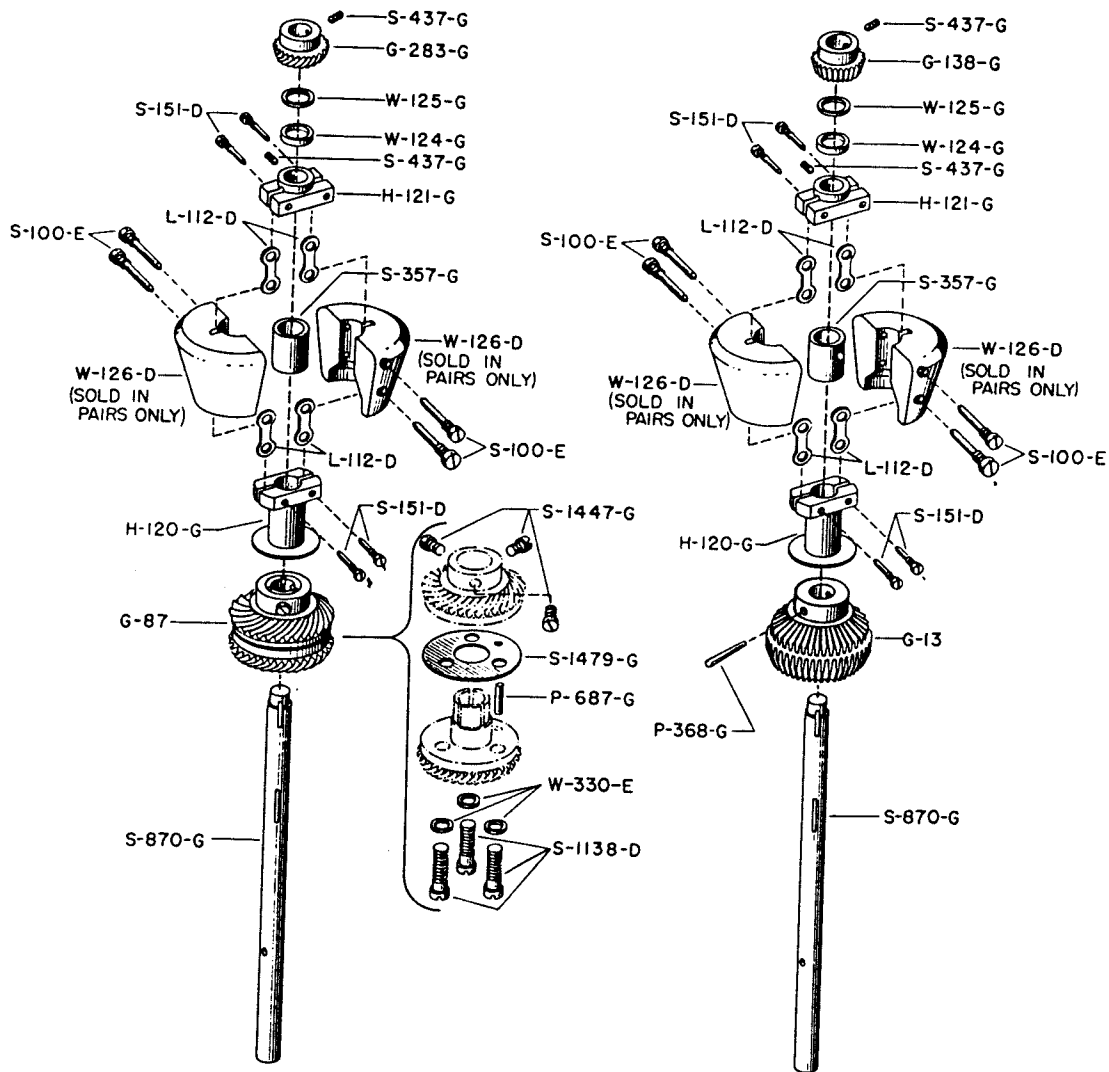

VERTICAL SHAFT
(WITH SPIRAL BEVEL GEARS)

VERTICAL SHAFT
(WITH STRAIGHT BEVEL GEARS)

VERTICAL SHAFT

VERTICAL SHAFT AND ASSOCIATED PARTS

ASSEMBLIES

- D-3 GOVERNOR WEIGHTS AND LINKS ASSEMBLY
L-112-D Governor Weight Link (2)
S-100-E Governor Weight Link Screw (4)
W-126-D Governor Weight (Sold in Matched Pairs only) (2)
- G-24 STRAIGHT DOUBLE BEVEL GEAR AND SHAFT ASSEMBLY
G-13 Straight Double Bevel Gear
P-368-G Straight Double Bevel Gear Taper Pin
S-870-G Vertical Shaft
- G-65 SPIRAL DOUBLE BEVEL GEAR AND SHAFT ASSEMBLY
G-87 Spiral Double Bevel Gear and Clamp Assembly
S-870-G Vertical Shaft
- G-87 SPIRAL DOUBLE BEVEL GEAR AND CLAMP ASSEMBLY (Included in G-65)
P-687-G Double Bevel Gear Locating Dowel Pin
S-1138-D Double Bevel Gear Fastening Screw (3)
S-1447-G Double Bevel Gear Clamp Collar Screw (3)
W-330-E Double Bevel Gear Fastening Screw Washer (3)

PARTS

- G-138-G Straight Bevel Gear
G-283-G Spiral Bevel Gear
H-120-G Governor Link Holder (Lower)
H-121-G Governor Link Holder (Upper)
S-151-D Governor Link Holder Screw (4)
S-357-G Governor Weight Stop
S-437-G Fastening Screw (for H-121-G, G-138-G and G-283-G) (2)
S-1479-G Double Spiral Bevel Gear Shim (.026")
S-1482-G Double Spiral Bevel Gear Shim (.015") Shims used
S-1483-G Double Spiral Bevel Gear Shim (.008") only when
S-1484-G Double Spiral Bevel Gear Shim (.005") required.
S-1485-G Double Spiral Bevel Gear Shim (.003")
W-124-G Vertical Shaft Washer (Lower: .094")
W-125-G Vertical Shaft Washer (Upper: .0625")

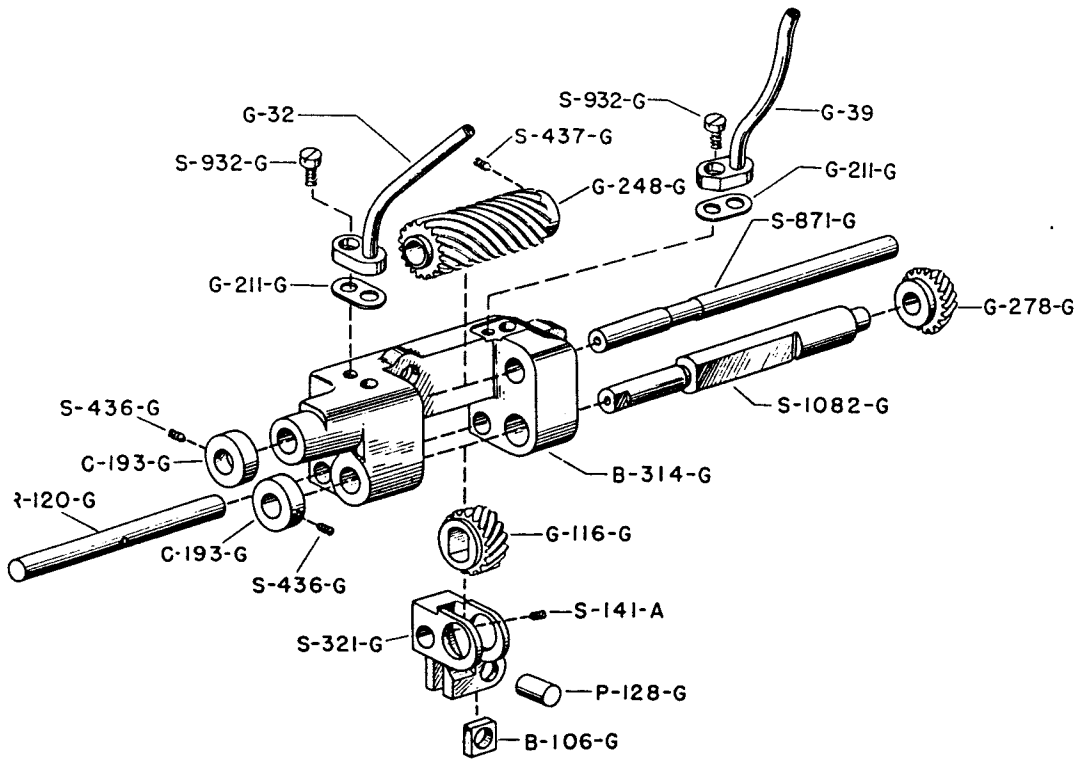

SHUTTER GEAR BRACKET
 (SPIRAL BEVEL TYPE)

SHUTTER GEAR BRACKET

(SPIRAL BEVEL GEAR TYPE)

G-78 SHUTTER GEAR BRACKET COMPLETE

ASSEMBLIES

G-4 FRAMING SLIDE AND BLOCK ASSEMBLY

B-106-G P-128-G S-321-G

G-73 SPIRAL BEVEL GEAR AND SHAFT ASSEMBLY

C-193-G G-278-G S-436-G S-1082-G

PARTS

B-106-G	Framing Slide Lever Block
B-314-G	Shutter Gear Bracket
C-193-G	Shaft Collar (for S-871-G and S-1082-G) (2)
G-116-G	Shutter Drive Gear
G-248-G	Shutter Shaft Spiral Gear (Formica)
G-278-G	Spiral Bevel Gear
P-128-G	Framing Slide Lever Pin
R-120-G	Framing Slide Guide Rod
S-141-A	Framing Slide Set Screw
S-321-G	Framing Slide
S-436-G	Shaft Collar Set Screw (2)
S-437-G	Shutter Shaft Spiral Gear Set Screw
S-871-G	Shutter Shaft
S-1082-G	Bevel Gear Drive Shaft

PARTS ILLUSTRATED BUT NOT INCLUDED IN ABOVE ASSEMBLY

G-32	Shutter Shaft Bracket Oil Tube and Flange (Front)
G-39	Shutter Shaft Bracket Oil Tube and Flange (Rear)
G-211-G	Shutter Shaft Bracket Oil Tube Gasket (2)
S-932-G	Shutter Shaft Bracket Oil Tube Fastening Screw (2)

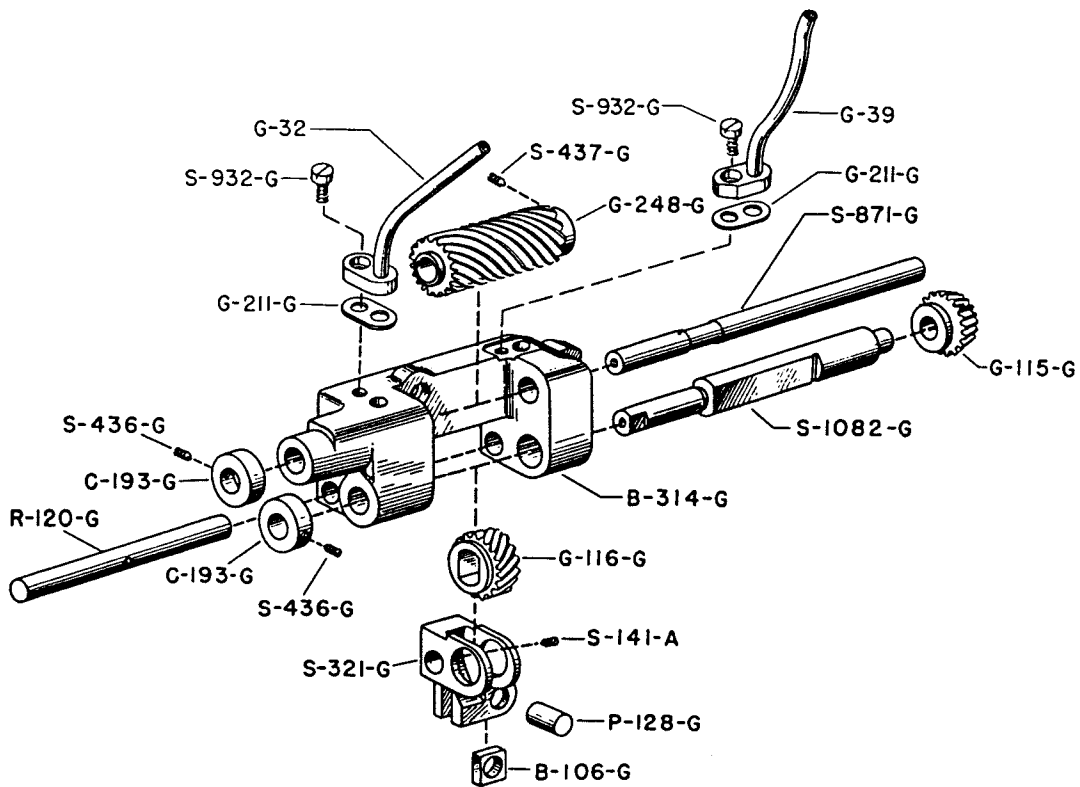

SHUTTER GEAR BRACKET
 (STRAIGHT BEVEL TYPE)

SHUTTER GEAR BRACKET

(STRAIGHT BEVEL GEAR TYPE)

G-30 SHUTTER GEAR BRACKET COMPLETE

ASSEMBLIES

G-4	FRAMING SLIDE AND BLOCK ASSEMBLY			
	B-106-G	P-128-G	S-321-G	
G-5	STRAIGHT BEVEL GEAR AND SHAFT ASSEMBLY			
	C-193-G	G-115-G	S-436-G	S-1082-G

PARTS

B-106-G	Framing Slide Lever Block
B-314-G	Shutter Gear Bracket
C-193-G	Shaft Collar (for S-871-G and S-1082-G) (2)
G-115-G	Straight Bevel Gear
G-116-G	Shutter Drive Gear
G-248-G	Shutter Shaft Spiral Gear (Formica)
P-128-G	Framing Slide Lever Pin
R-120-G	Framing Slide Guide Rod
S-141-A	Framing Slide Set Screw
S-321-G	Framing Slide
S-436-G	Shaft Collar Set Screw (2)
S-437-G	Shutter Shaft Spiral Gear Set Screw
S-871-G	Shutter Shaft
S-1082-G	Bevel Gear Drive Shaft

PARTS ILLUSTRATED BUT NOT INCLUDED IN ABOVE ASSEMBLY

G-32	Shutter Gear Bracket Oil Tube and Flange (Front)
G-39	Shutter Gear Bracket Oil Tube and Flange (Rear)
G-211-G	Shutter Gear Bracket Oil Tube Gasket (2)
S-932-G	Shutter Gear Bracket Oil Tube Fastening Screw (2)

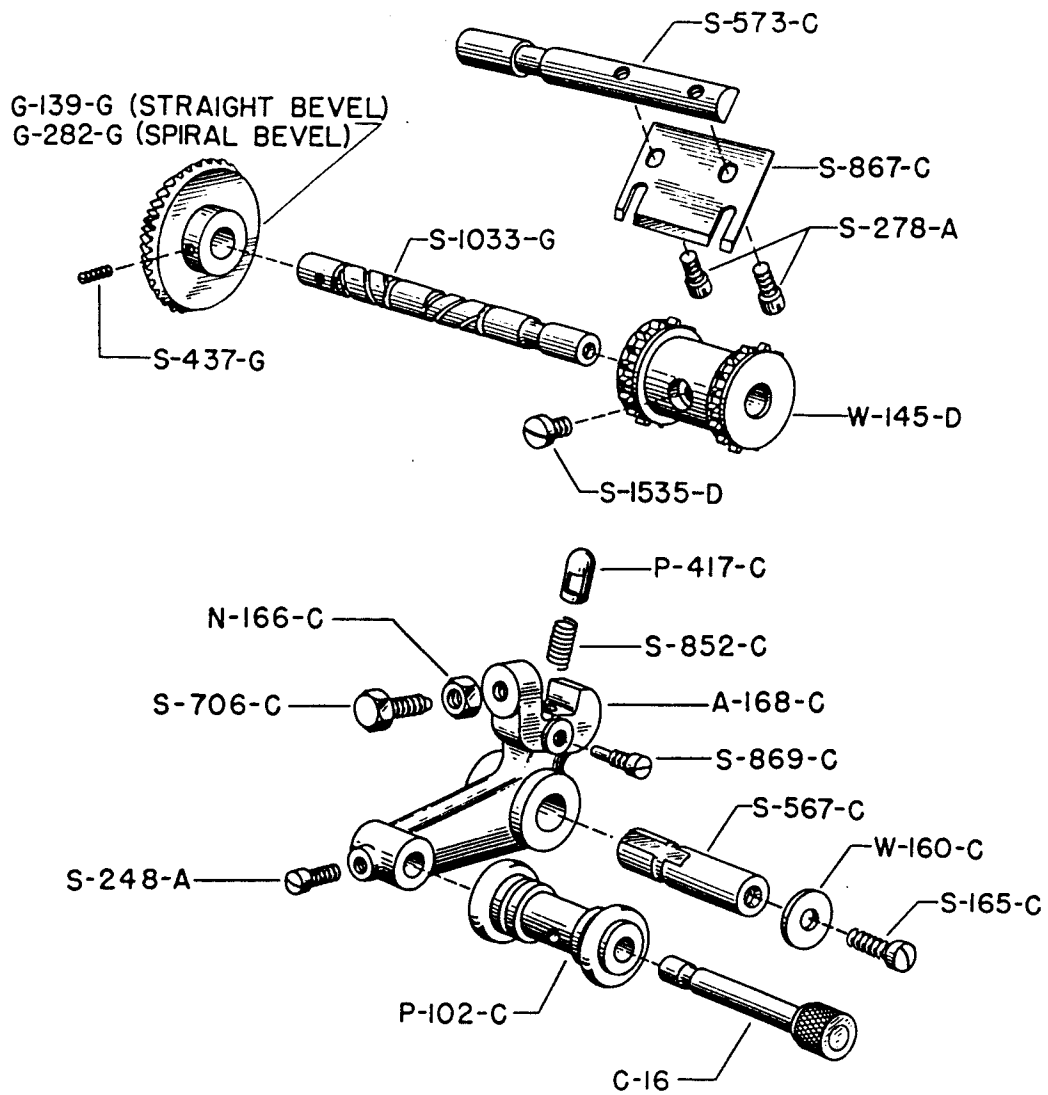

UPPER SPROCKET AND ASSOCIATED PARTS

UPPER SPROCKET AND ASSOCIATED PARTS

ASSEMBLIES

C-20 UPPER PAD ROLLER ARM ASSEMBLY

A-168-C	Upper Pad Roller Arm
C-16	Pad Roller Stud and Knob
N-166-C	Pad Roller Arm Adjusting Nut
P-102-C	Pad Roller
P-417-C	Upper Pad Roller Arm Plunger
S-248-A	Pad Roller Stud and Knob Retaining Screw
S-706-C	Pad Roller Arm Adjusting Screw
S-852-C	Upper Pad Roller Arm Plunger Spring
S-869-C	Upper Pad Roller Arm Plunger Retaining Screw

PARTS

G-139-G	Upper Sprocket Shaft Gear - Straight Bevel
G-282-G	Upper Sprocket Shaft Gear - Spiral Bevel
S-165-C	Pad Roller Arm Stud Washer Retaining Screw
S-278-A	Upper Sprocket Stripper Plate Fastening Screw (2)
S-437-G	Upper Sprocket Shaft Gear Fastening Screw
S-567-C	Upper Pad Roller Arm Stud
S-573-C	Upper Sprocket Stripper Plate Stud
S-867-C	Upper Sprocket Stripper Plate
S-1033-G	Upper Sprocket Shaft (See note below)
S-1535-D	Upper Sprocket Fastening Screw
→ W-145-D	Upper Sprocket LAVEZZI # 416 FL 31B
W-160-C	Pad Roller Arm Stud Retaining Washer

NOTE: The S-1033-G Upper Sprocket Shaft is available in the Standard Diameter or in any of the following Oversizes: .0015", .0025", .0035", .0045" and 0055". Specify the exact size desired. Otherwise the Standard Diameter will be furnished.

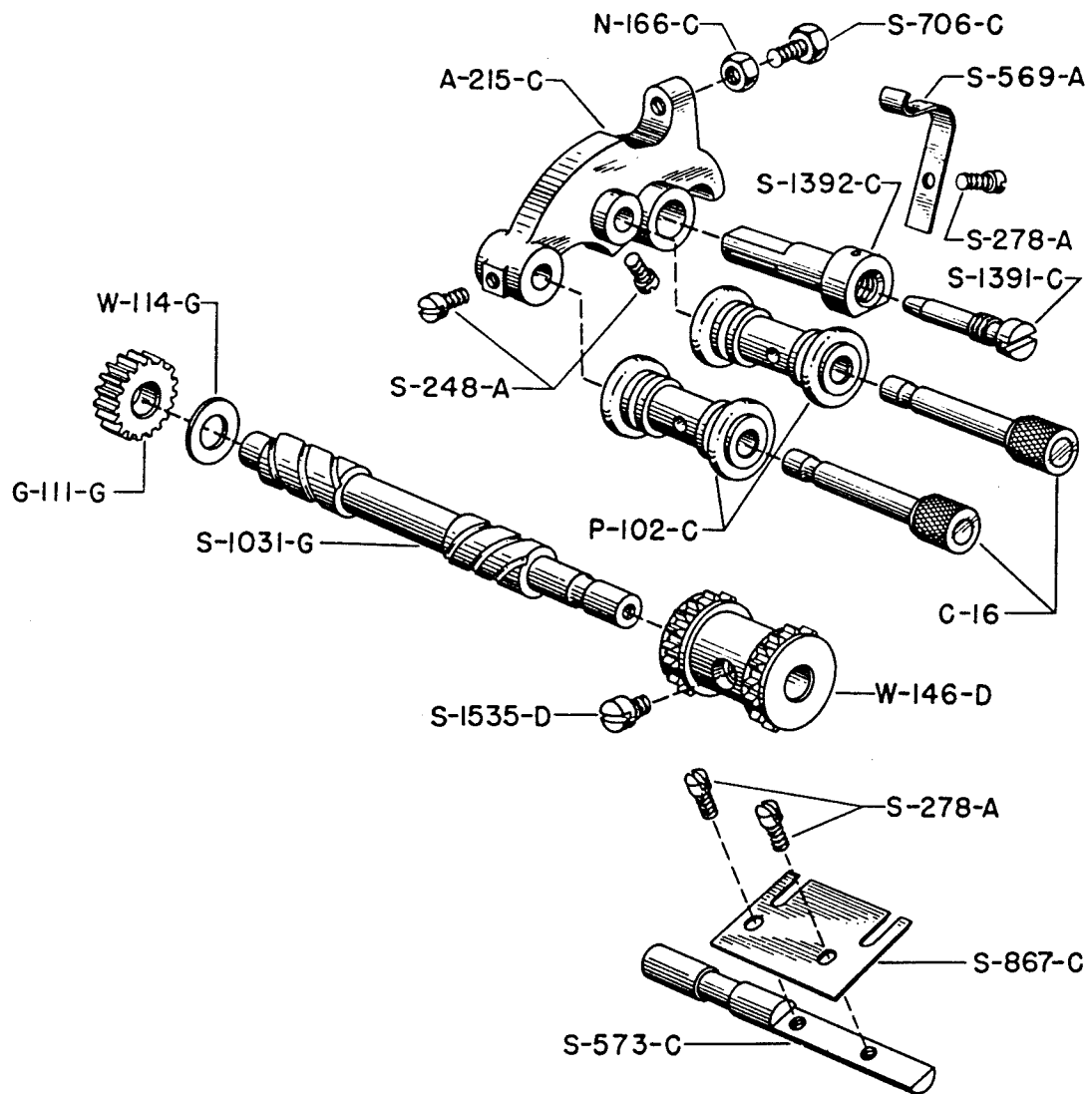

LOWER SPROCKET AND ASSOCIATED PARTS

LOWER SPROCKET AND ASSOCIATED PARTS

ASSEMBLIES

C-21 LOWER PAD ROLLER ARM ASSEMBLY

A-215-C Lower Pad Roller Arm
C-16 Lower Pad Roller Arm Stud and Knob (2)
N-166-C Lower Pad Roller Arm Adjusting Nut
P-102-C Pad Roller (2)
S-248-A Pad Roller Stud and Knob Retaining Screw (2)
S-706-C Pad Roller Arm Adjusting Screw

C-59 PAD ROLLER ARM STUD AND SCREW ASSEMBLY

S-1391-C Pad Roller Arm Stud Screw
S-1392-C Pad Roller Arm Stud

G-35 LOWER SPROCKET SHAFT AND GEAR ASSEMBLY (See note below)

G-111-G Lower Sprocket Shaft Gear
S-1031-G Lower Sprocket Shaft
W-114-G Lower Sprocket Shaft Washer

NOTE: The G-35 Assembly is made up with S-1031-G Shaft in the Standard Diameter or in any of the following Oversizes: .001", .002", .003", .004" and .005". In ordering either the G-35 Assembly or the S-1031-G Part, specify the exact size desired. Otherwise the Standard Diameter will be furnished.

PARTS

S-278-A Fastening Screw (for S-272-C and S-569-A) (3)
S-569-A Lower Sprocket Arm Spring
S-573-C Lower Sprocket Stripper Plate Stud
S-867-C Lower Sprocket Stripper Plate
S-1535-D Lower Sprocket Fastening Screw
→ W-146-D Lower Sprocket LAVEZZI # 416 GL 31 B

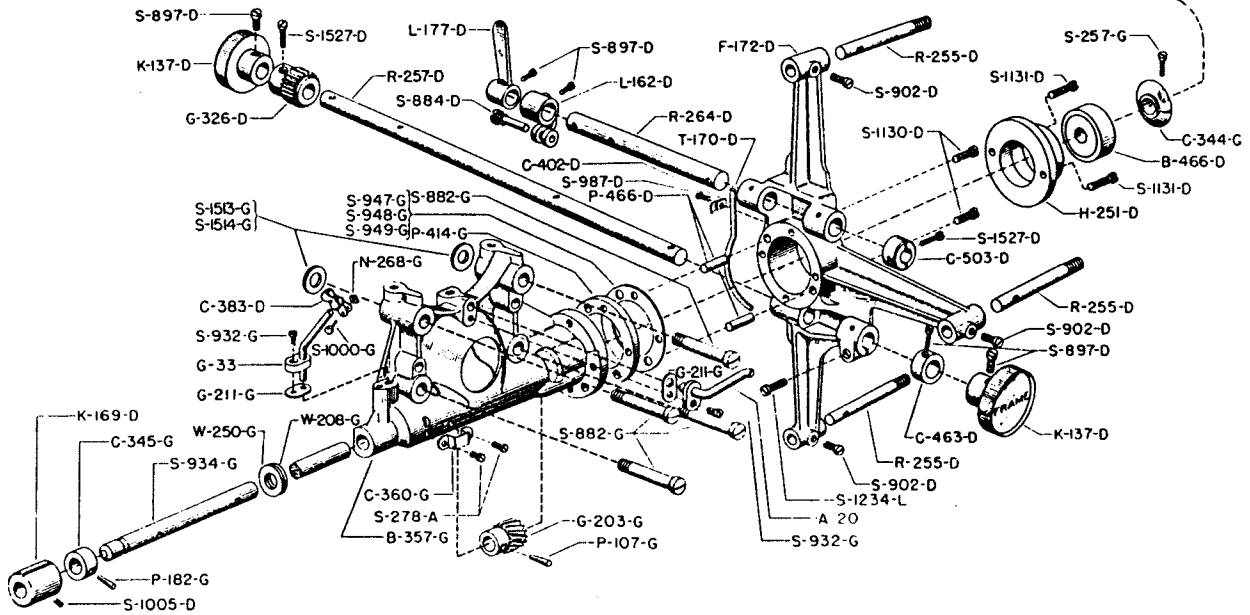
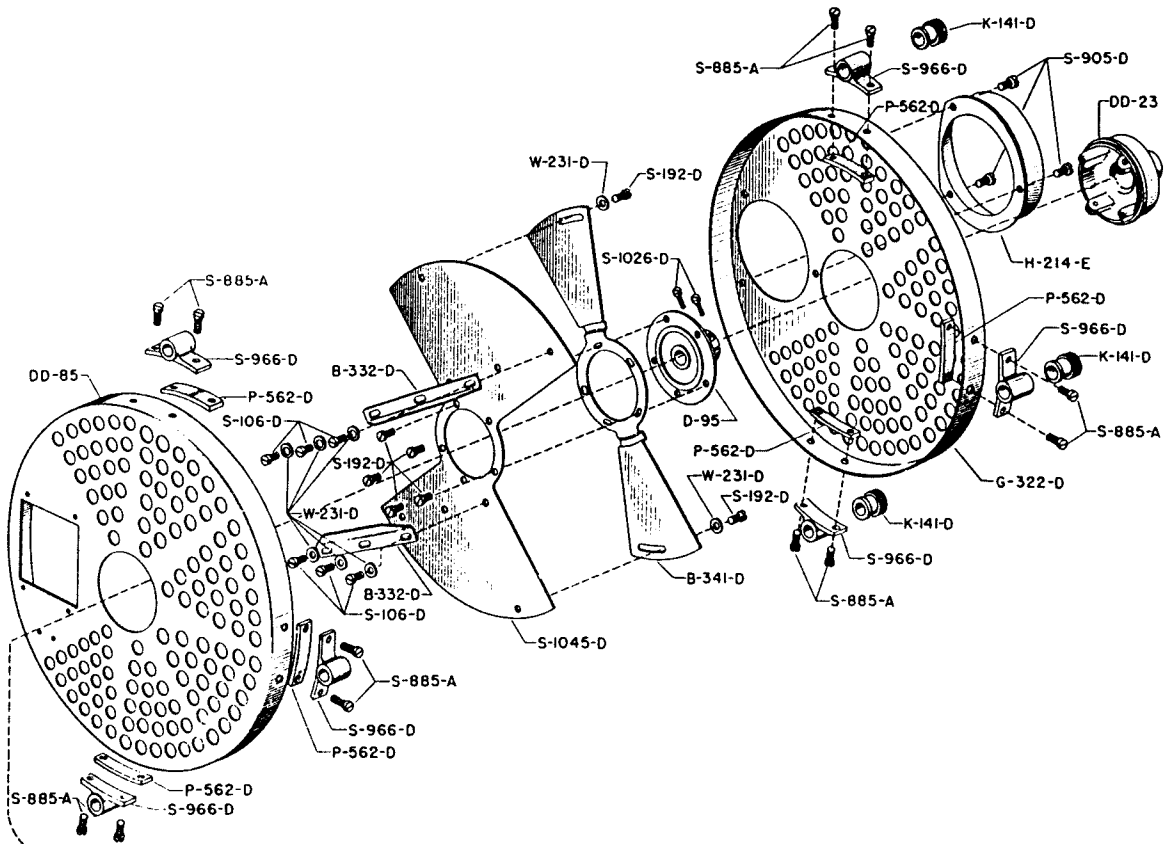

REAR SHUTTER

REAR SHUTTER AND ASSOCIATED PARTS

ASSEMBLIES

- D-74 REAR SHUTTER GUARD ASSEMBLY (Front Section)**
DD-85 Rear Shutter Guard (Front Section)
P-562-D Shutter Guard Holding Support Plate (3)
S-885-D Shutter Guard Holding Support Fastening Screw (6)
S-966-D Shutter Guard Holding Support (3)
- D-75 REAR SHUTTER GUARD ASSEMBLY (Rear Section)**
G-322-D Rear Shutter Guard (Rear Section)
P-562-D Shutter Guard Holding Support Plate (3)
S-885-D Shutter Guard Holding Support Fastening Screw (6)
S-966-D Shutter Guard Holding Support (3)
- D-89 TWO-WING ADJUSTABLE SHUTTER ASSEMBLY**
B-332-D Shutter Fan Blade (2)
B-341-D Shutter Adjustable Blade
S-106-D Shutter Fan Blade Fastening Screw (6)
S-192-D Shutter Fastening Screw (2)
S-1045-D Shutter Main Blade
W-231-D Shutter Fan Blade Screw Washer (8)
- D-95 SHUTTER SPIDER ASSEMBLY**
S-1026-D Shutter Spider Clamp Screw (2)
- DD-6 REAR SHUTTER BRACKET BALL BEARING ASSEMBLY**
B-466-D Rear Shutter Bracket Ball Bearing
G-28 Shutter Shaft Clamp Assembly
H-251-D Ball Bearing Housing
S-1130-D Rear Shutter Bracket Fastening Screw (2)
S-1131-D Ball Bearing Housing Fastening Screw (2)
- G-27 SHUTTER SHAFT AND GEAR ASSEMBLY**
C-345-G Shutter Shaft Collar
G-203-G Shutter Shaft Gear
P-107-G Shutter Shaft Gear Pin
P-182-G Shutter Shaft Collar Taper Pin
S-934-G Shutter Shaft
- G-28 SHUTTER SHAFT CLAMP ASSEMBLY (Included in DD-6)**
C-344-G Shutter Shaft Clamp Collar
S-257-G Shutter Shaft Clamp Collar Screw

PARTS

- A-20 Vertical Shaft Oil Tube (Upper)
B-357-G Rear Shutter Bracket
C-360-G Rear Shutter Bracket Oil Tube Clamp
C-383-D Oil Tube Clamp (for G-33)
C-402-D Shutter Guard Support Frame Oil Tube Clamp

REAR SHUTTER AND ASSOCIATED PARTS (continued)

C-463-D	Framing Gear Handle Rod Collar
C-503-D	Film Trap Door Opening Rod Collar
DD-23	Rear Shutter Light Cap
F-172-D	Shutter Guard Support Frame
G-33	Rear Shutter Bracket Oil Tube
G-211-G	Oil Tube Gasket (2)
G-326-D	Framing Gear
H-214-E	Fire Shield Hood
K-137-D	Framing Gear Handle Knob (2)
K-141-D	Cover Holding Support Rod Knob (3)
K-169-D	Shutter Shaft Indicator Knob
L-162-D	Film Trap Door Opening Lever
L-177-D	Film Trap Door Lever
N-268-G	Oil Tube Clamp Screw Nut
P-414-G	Rear Shutter Bracket Distance Piece
P-466-D	Rear Shutter Bracket Dowel Pin (2)
R-255-D	Cover Holding Support Rod (3)
R-257-D	Framing Gear Handle Rod
R-264-D	Film Trap Door Opening Rod
S-192-D	Shutter Fastening Screw (5)
S-278-A	Oil Tube Clamp Fastening Screw (2)
S-882-G	Rear Shutter Bracket Fastening Screw (4)
S-884-D	Door Opening Lever Stop Screw
S-897-D	Fastening Screw (for C-463-D, K-137-D, L-162-D and L-177-D) (5)
S-902-D	Cover Holding Support Rod Fastening Screw (3)
S-905-D	Fire Shield Hood Fastening Screw (3)
S-932-G	Fastening Screw (for A-20 and G-33) (2)
S-947-G	Rear Shutter Bracket Shim (.003") Shims, used only
S-948-G	Rear Shutter Bracket Shim (.005") when required.
S-949-G	Rear Shutter Bracket Shim (.007")
S-987-D	Shutter Support Frame Oil Tube Clamp Fastening Screw
S-1000-G	Oil Tube Clamp Screw (for C-383-D)
S-1005-D	Shutter Shaft Indicator Knob Fastening Screw
S-1234-L	Shutter Guard Support Frame Clamp Screw
S-1513-G	Rear Shutter Bracket Mounting Shim (.005")Used only
S-1514-G	Rear Shutter Bracket Mounting Shim (.003")as required.
S-1527-D	Fastening Screw (for C-503-D and G-326-D) (2)
T-170-D	Shutter Guard Support Frame Oil Tube
W-208-G	Shutter Shaft Thrust Washer (Steel)
W-250-G	Shutter Shaft Thrust Washer (Fibre)

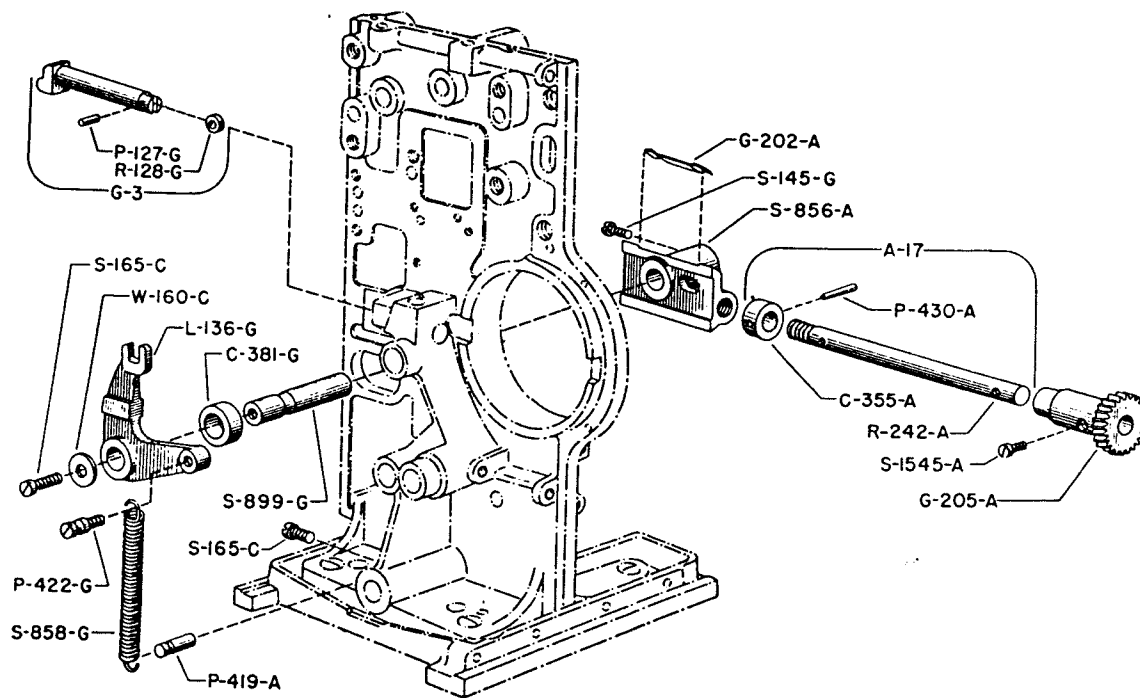

SHUTTER ADJUSTING AND FRAMING DEVICES

ASSEMBLIES

A-17 SHUTTER ADJUSTING ROD ASSEMBLY

C-355-A Shutter Adjusting Rod Collar
 P-430-A Shutter Adjusting Rod Collar Pin
 R-242-A Shutter Adjusting Rod

G-3 FRAMING SLIDE ARM AND ROLLER ASSEMBLY

P-127-G Framing Slide Arm Roller Pin
 R-128-G Framing Slide Arm Roller

PARTS

C-381-G Framing Slide Lever Spacer Collar
 G-202-A Shutter Adjusting Slide Gib
 G-205-A Shutter Adjusting Gear
 L-136-G Framing Slide Lever
 P-419-A Framing Slide Lever Spring Stud
 P-422-G Framing Slide Lever Spring Pin
 S-145-G Framing Slide Lever Stud Retaining Screw
 S-165-C Retaining Screw (for L-136-G and P-419-A) (2)
 S-856-C Shutter Adjusting Slide
 S-858-G Framing Slide Lever Spring
 S-899-G Framing Slide Lever Stud
 S-1545-A Shutter Adjusting Gear Fastening Screw
 W-160-C Framing Slide Lever Retaining Screw Washer

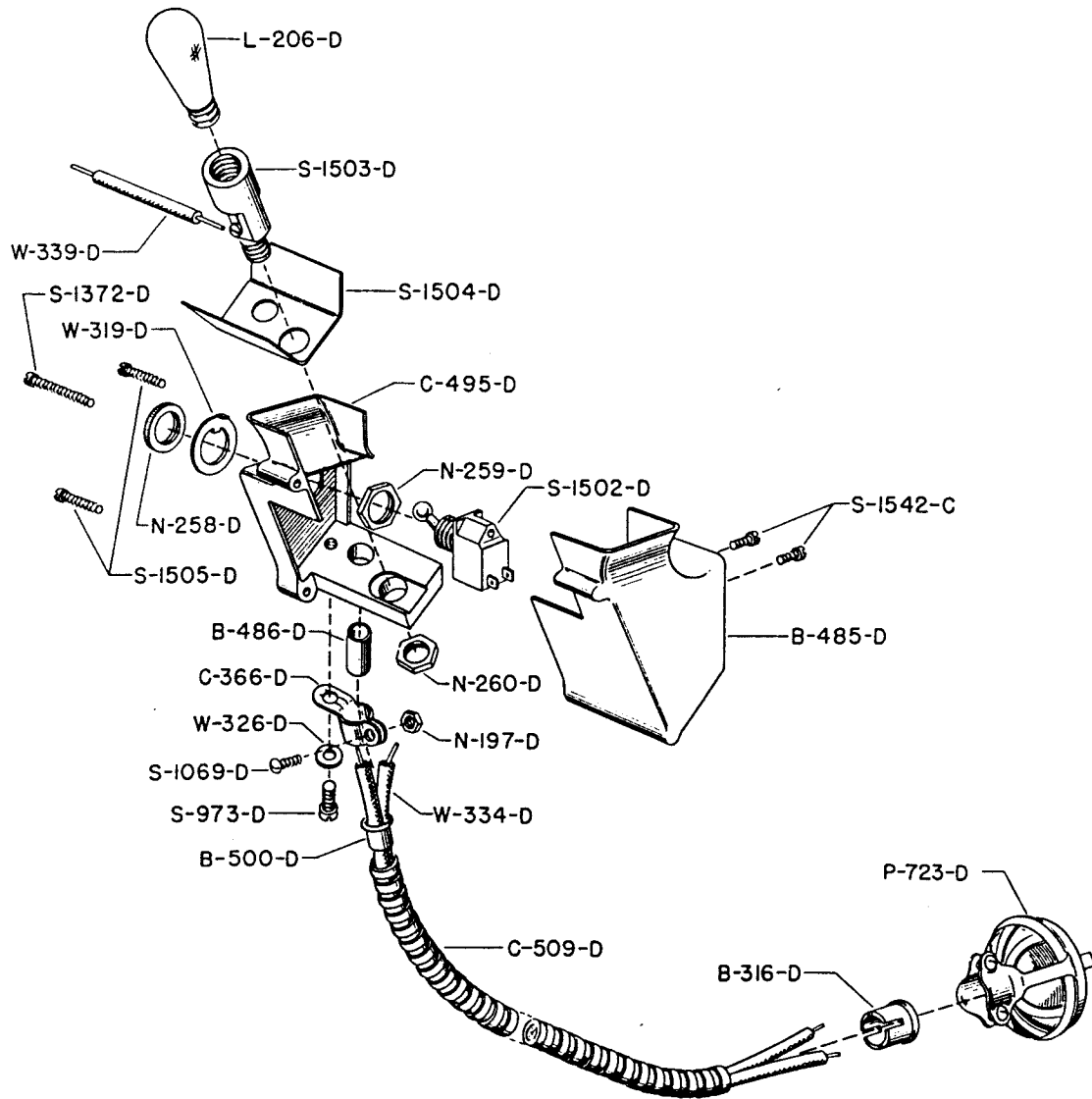

THREADING LAMP

THREADING LAMP

DD-73 THREADING LAMP COMPLETE

PARTS

B-316-D	Threading Lamp Cable Bushing
B-485-D	Threading Lamp Box
B-486-D	Threading Lamp Bushing
B-500-D	Threading Lamp Cable Wire Safety Bushing
C-366-D	Threading Lamp Cable Clamp
C-495-D	Threading Lamp Box Cover
C-509-D	Flexible Conduit (4 feet)
L-206-D	Mazda Lamp (6S6, 120 Volt, Clear)
N-197-D	Threading Lamp Cable Clamp Nut
N-258-D	Lock Nut (for S-1502-D)
N-260-D	Retaining Nut (for S-1503-D)
P-723-D	AC Supply Plug
S-973-D	Threading Lamp Cable Clamp Fastening Screw
S-1069-D	Threading Lamp Cable Clamp Screw
S-1372-D	Threading Lamp Box Cover Fastening Screw (Long)
S-1502-D	Threading Lamp Switch
S-1503-D	Threading Lamp Socket
S-1504-D	Threading Lamp Shield
S-1505-D	Threading Lamp Box Cover Fastening Screw (Short) (2)
S-1542-C	Threading Lamp Assembly Fastening Screw (2)
W-319-D	Threading Lamp Switch Washer
W-326-D	Cable Clamp Washer
W-334-D	Flexible Wire (4' - 7") (2)
W-339-D	Flexible Wire (2")

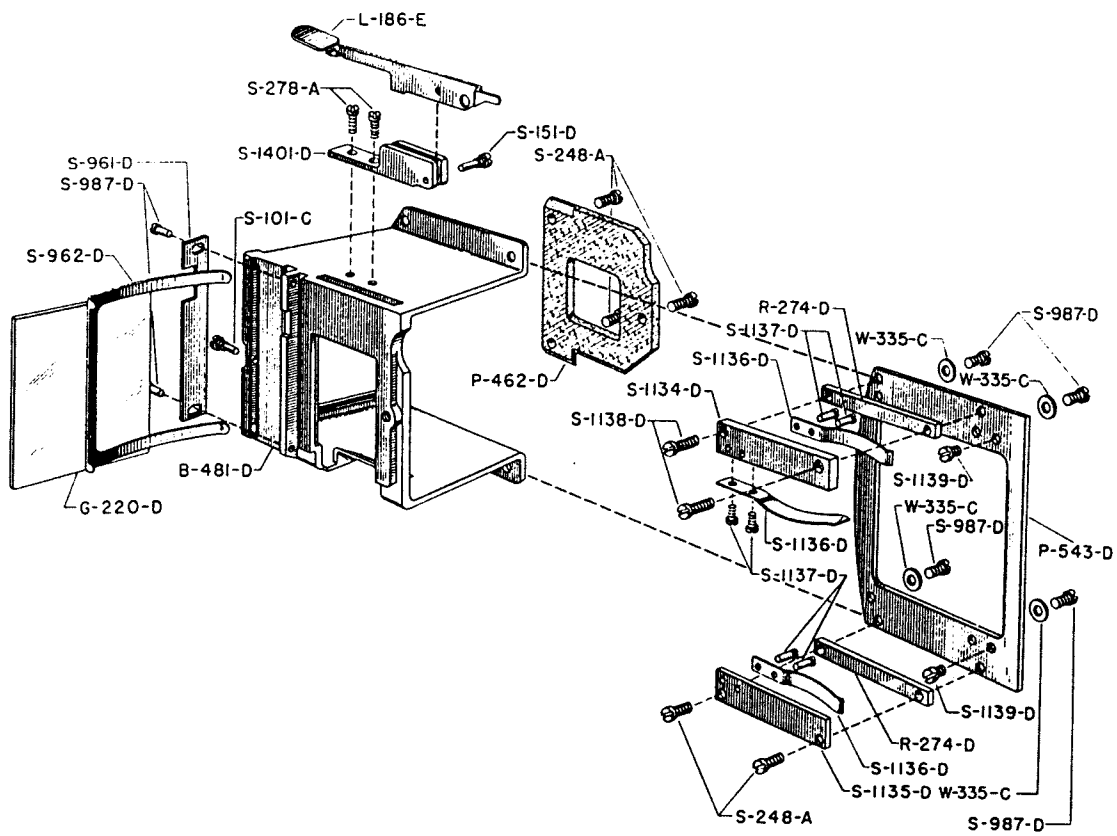

SPOT SIGHT BOX AND MOUNT

SPOT SIGHT BOX AND MOUNT

D-64 SPOT SIGHT BOX COMPLETE

ASSEMBLIES

D-67 SPOT SIGHT BOX AND LIFT LEVER SUPPORT ASSEMBLY
B-481-D S-278-A (2) S-1401-D

PARTS

B-481-D Spot Sight Box
G-220-D Spot Sight Glass
L-186-D Automatic Fire Shutter Lift Lever
P-462-D Cooling Plate
S-101-C Spot Sight Glass Retaining Screw
S-151-D Automatic Fire Shutter Lift Lever Pivot Screw
S-248-A Cooling Plate Fastening Screw (3)
S-278-A Automatic Fire Shutter Lift Lever Support
Fastening Screw (2)
S-961-D Light Seal
S-962-D Spot Sight Glass Tension Spring
S-987-D Light Seal Fastening Screw (2)
S-1401-D Automatic Fire Shutter Lift Lever Support

DD-4 SPOT SIGHT BOX MOUNT COMPLETE

PARTS

P-543-D Spot Sight Box Seating Plate
R-274-D Spot Sight Box Guide Rail (2)
S-248-A Lower Retaining Strip Fastening Screw (2)
S-987-D Seating Plate Fastening Screw (4)
S-1134-D Upper Retaining Strip
S-1135-D Lower Retaining Strip
S-1136-D Spot Sight Box Retaining Spring (3)
S-1137-D Spot Sight Box Retaining Spring Fastening Screw (6)
S-1138-D Upper Retaining Strip Fastening Screw (2)
S-1139-D Spot Sight Box Stop Screw (2)
W-335-C Seating Plate Fastening Screw Washer (4)

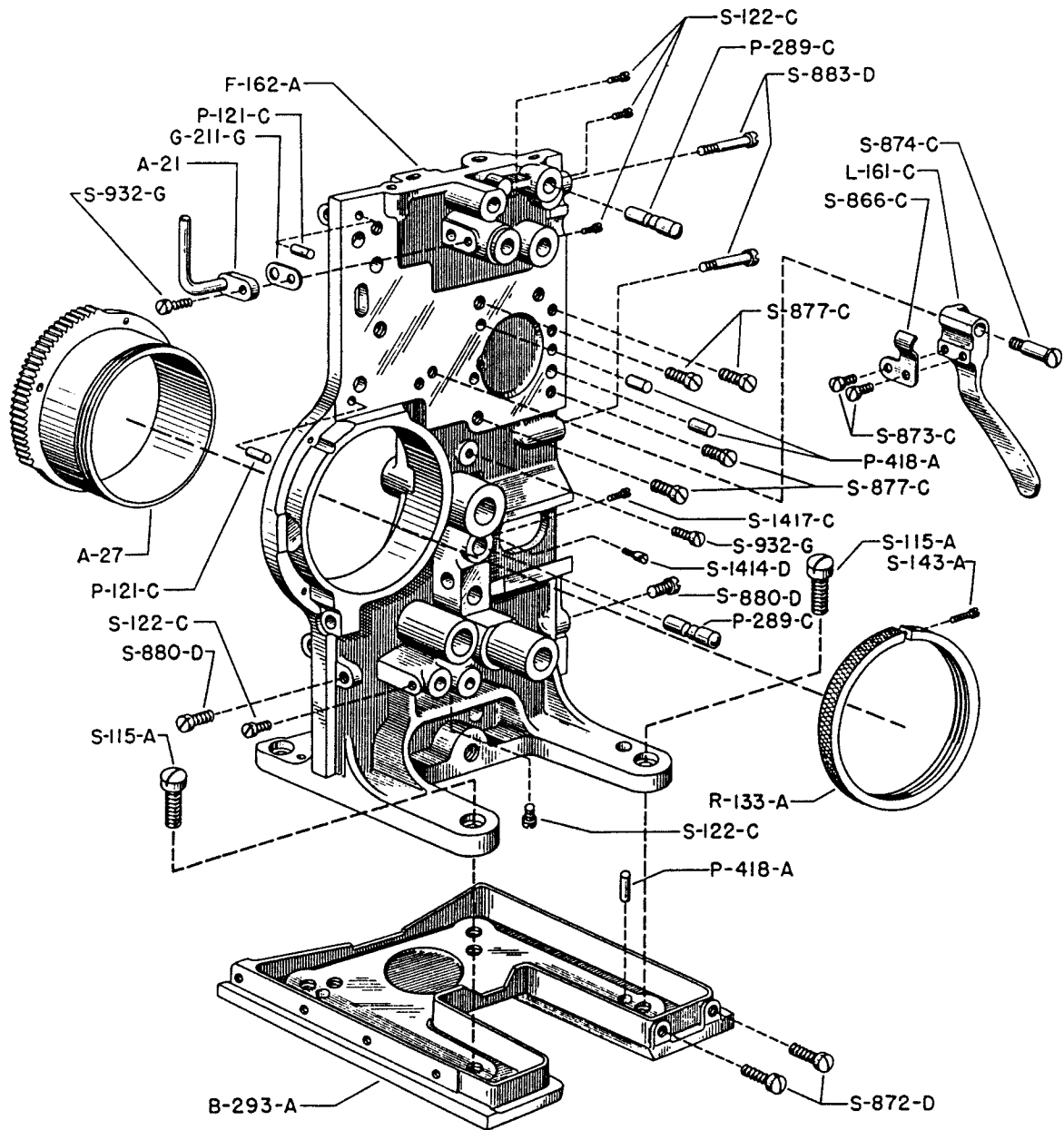

MAIN FRAME — FILM SIDE

MAIN FRAME—FILM SIDE

ASSEMBLIES

- C-25 FILM TRAP DOOR TRIP LEVER ASSEMBLY
- L-161-C Film Trap Door Trip Lever
 - S-866-C Film Trap Door Trip Lever Spring
 - S-873-C Film Trap Door Trip Lever Spring Fastening Screw (2)

PARTS

- A-21 Upper Sprocket Shaft Oil Tube
- A-27 Framing Cam
- B-293-A Mechanism Base
- F-162-A Mechanism Main Frame
- G-211-G Upper Sprocket Shaft Oil Tube Gasket
- P-121-C Film Trap Locating Pin (2)
- P-289-C Pad Roller Arm Stop Stud (2)
- P-418-A Locating Pin (for Lens Holder and Main Frame)
- R-133-A Framing Cam Ring
- S-115-A Main Frame Fastening Screw (2)
- S-122-C Fastening Screw (for P-289-C, S-567-C and S-573-C) (5)
- S-143-A Framing Cam Ring Clamping Screw
- S-872-D Film Side Lower Cover Fastening Screw (2)
- S-874-C Film Trap Door Trip Lever Pivot Screw
- S-877-C Lens Holder Fastening Screw (4)
- S-880-D Fastening Screw (for C-339-D and C-340-D) (2)
- S-883-D Fastening Screw (for C-340-D) (2)
- S-932-G Fastening Screw (for A-21) and Oil Hole Plug Screw (2)
- S-1414-D Shutter Adjusting Slide Holding Screw
- S-1417-C Lower Pad Roller Arm Stop Stud Retaining Screw

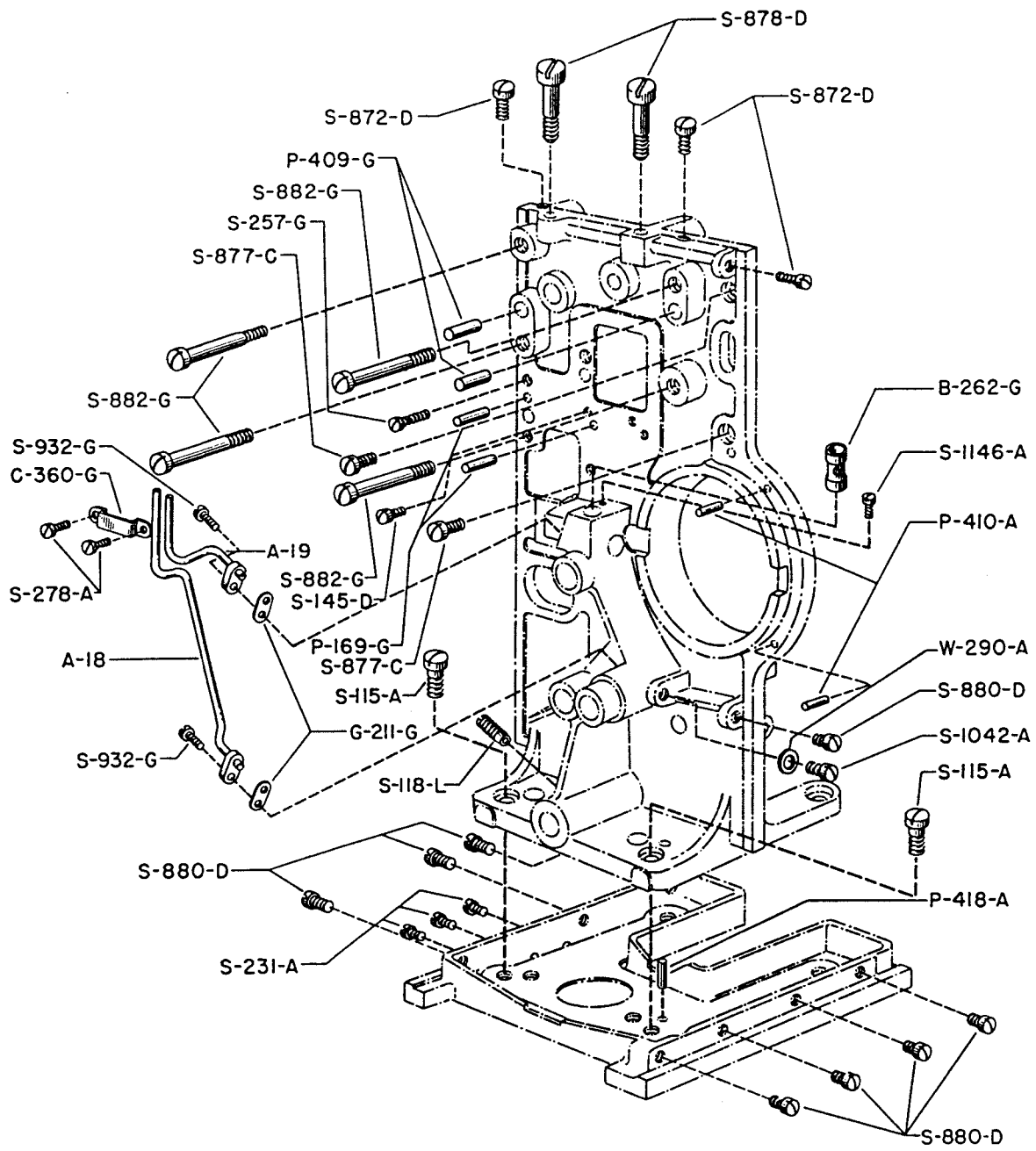

MAIN FRAME — GEAR SIDE

MAIN FRAME—GEAR SIDE

PARTS

A-18	Main Drive Shaft and Lower Sprocket Shaft Oil Tube
A-19	Intermediate Shaft and Vertical Shaft Oil Tube
B-262-G	Vertical Shaft Replacement Bearing
C-360-G	Oil Tube Clamp
G-211-G	Oil Tube Gasket (2)
P-169-G	Shutter Gear Bracket Dowel Pin (2)
P-409-G	Rear Shutter Bracket Dowel Pin (2)
P-410-A	Framing Cam Pin (2)
P-418-A	Main Frame Dowel Pin
S-115-A	Main Frame Fastening Screw (2)
S-118-L	Sound Pinion Shaft Retaining Screw
S-145-D	Shutter Gear Bracket Rear Fastening Screw
S-231-A	Mechanism Base Oil Drain Screw (3)
S-257-G	Shutter Gear Bracket Front Fastening Screw
S-278-A	Oil Tube Clamp Fastening Screw (2)
S-872-D	Fastening Screw (for C-342-D and P-408-D) (3)
S-877-C	Film Trap Fastening Screw (2)
S-878-D	Upper Magazine Fastening Screw (2)
S-880-D	Fastening Screw (for C-339-D, C-340-D and C-342-D) (8)
S-882-D	Rear Shutter Bracket Fastening Screw (4)
S-932-G	Oil Tube Fastening Screw (2)
S-1042-A	Oil Hole Plug Screw (Upper)
S-1146-A	Oil Hole Plug Screw (Lower)
W-290-A	Washer (for S-1042-A Screw)

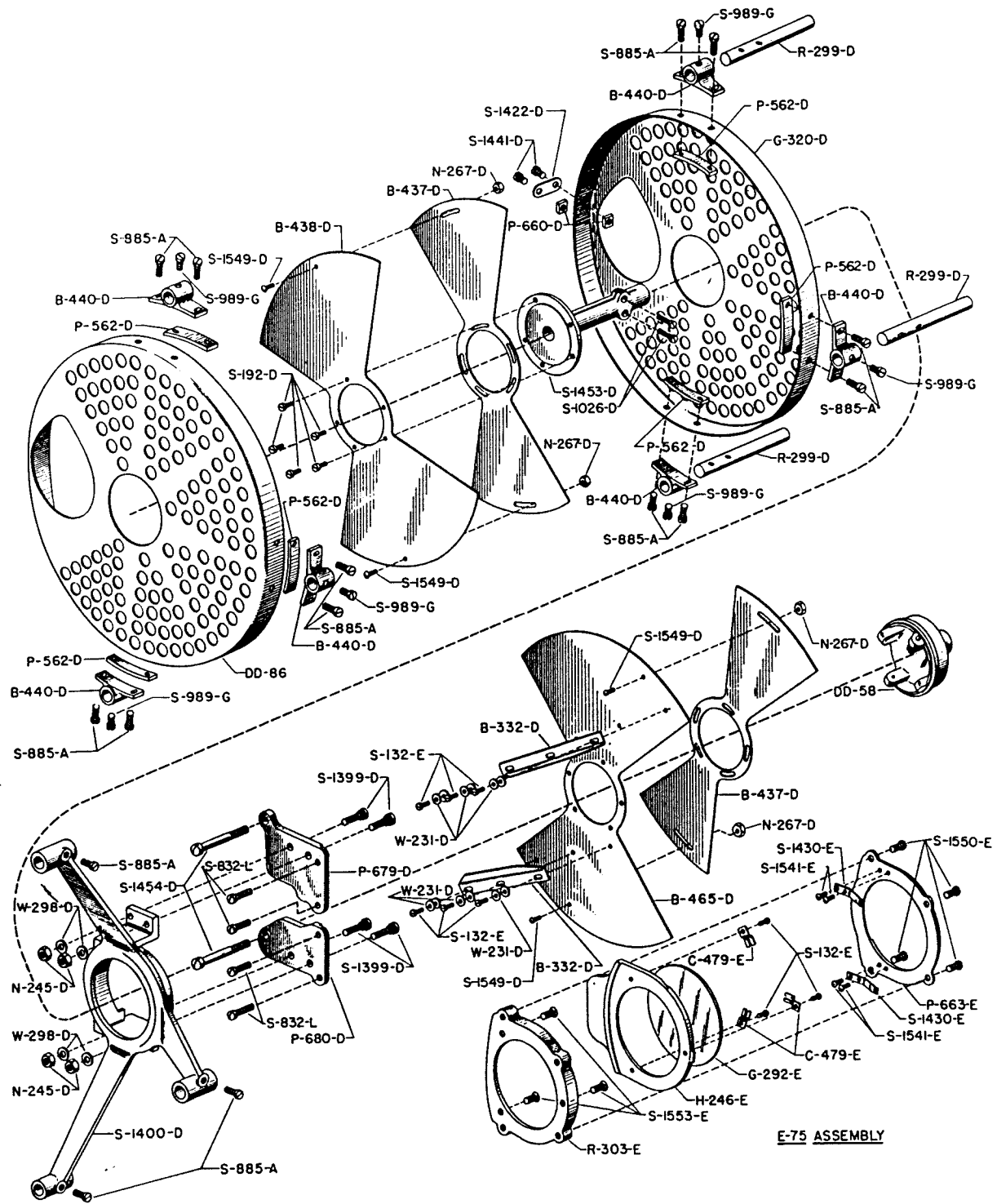

E-75 ASSEMBLY

FRONT SHUTTER ATTACHMENT

FRONT SHUTTER ATTACHMENT

DD-67 FRONT SHUTTER ATTACHMENT COMPLETE

ASSEMBLIES

DD-59	FRONT SHUTTER UPPER MOUNTING PLATE AND STUD ASSEMBLY			
	P-679-D	S-1399-D (2)		
DD-60	FRONT SHUTTER LOWER MOUNTING PLATE AND STUD ASSEMBLY			
	P-680-D	S-1399-D (2)		
DD-61	SHUTTER SPIDER ASSEMBLY (Included in DD-63)			
	S-1026-D (2)	S-1453-D		
DD-62	REAR SHUTTER BLADE ASSEMBLY			
	B-332-D	B-465-D	S-132-E (6)	S-1549-D (2)
	B-437-D	N-267-D (2)		
DD-63	FRONT SHUTTER BLADE AND SPIDER ASSEMBLY			
	B-437-D	DD-61	S-192-D (5)	S-1549-D (2)
	B-438-D	N-267-D (2)		
DD-70	ACCESSORY KIT			
	H-242-R	K-168-C	S-1404-R	W-317-D
	I-114-R	R-301-R	S-1491-C	
E-75	AIR DEFLECTOR AND APERTURE COOLING UNIT			
	C-479-E	H-246-E	S-132-E (3)	S-1550-E (4)
	DD-58	P-663-E	S-1430-E (2)	S-1553-E (3)
	G-292-E	R-303-E	S-1541-E (4)	

PARTS

B-332-D	Shutter Fan Blade (2)
B-437-D	Shutter Adjusting Blade (2)
B-438-D	Front Shutter Main Blade
B-440-D	Front Shutter Guard Bracket (6)
B-465-D	Rear Shutter Main Blade
C-479-E	Glass Retaining Clip (3)
DD-58	Rear Shutter Guard Light Cap
DD-86	Front Shutter Guard (Front Section)
G-292-E	Fire Shield Hood Glass
G-320-D	Front Shutter Guard (Rear Section)
H-242-R	Shutter Aligning Rod Holder
H-246-E	Fire Shield Hood Glass Holder
I-114-R	Movement Indicator
K-168-C	Lens Carrier Adjusting Knob
N-245-D	Front Shutter Guard Stud Nut (4)
N-267-D	Nut (for S-1549-D) (4)

FRONT SHUTTER ATTACHMENT (continued)

P-562-D	Shutter Guard Holding Support Plate (6)
P-660-D	Front Shutter Guard Strap Plate (2)
P-663-E	Fire Shield Hood Plate
P-679-D	Front Shutter Upper Mounting Plate
P-680-D	Front Shutter Lower Mounting Plate
R-299-D	Front Shutter Guard Support Rod (3)
R-301-R	Shutter Aligning Rod
R-303-E	Glass Holder Retainer
S-132-E	Fastening Screw (for B-332-D and C-479-E) (9)
S-192-D	Shutter Spider Fastening Screw (5)
S-832-L	Fastening Screw (for P-679-D and P-680-D) (4)
S-885-A	Fastening Screw (for B-440-D and S-1400-D) (15)
S-989-G	Shutter Guard Retaining Screw (6)
S-1026-D	Shutter Spider Clamp Screw (2)
S-1399-D	Front Shutter Guard Stud (4)
S-1400-D	Front Shutter Guard Support
S-1404-R	Aligning Rod Holding Screw
S-1422-D	Front Shutter Guard Strap
S-1430-E	Slide Pressure Spring (2)
S-1441-D	Front Shutter Guard Strap Screw (2)
S-1453-D	Front Shutter Spider
S-1454-D	Fastening Screw (for P-679-D and P-680-D) (2)
S-1491-C	Lens Carrier Adjusting Knob Fastening Screw
S-1541-E	Slide Pressure Spring Screw (4)
S-1549-D	Adjusting Blade Fastening Screw (4)
S-1550-E	Fire Shield Hood Plate Screw (4)
S-1553-E	Glass Holder Retainer Screw (3)
W-231-D	Washer (for S-132-E Screw - 2 used under each Screw) (12)
W-298-D	Front Shutter Guard Stud Washer (4)
W-317-D	Lens Carrier Adjusting Knob Washer

DD-70 ACCESSORY KIT

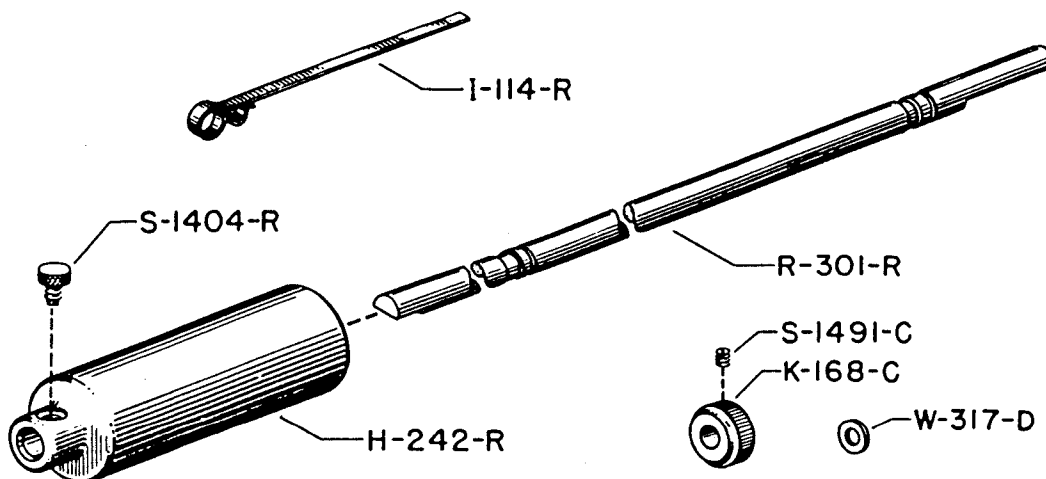

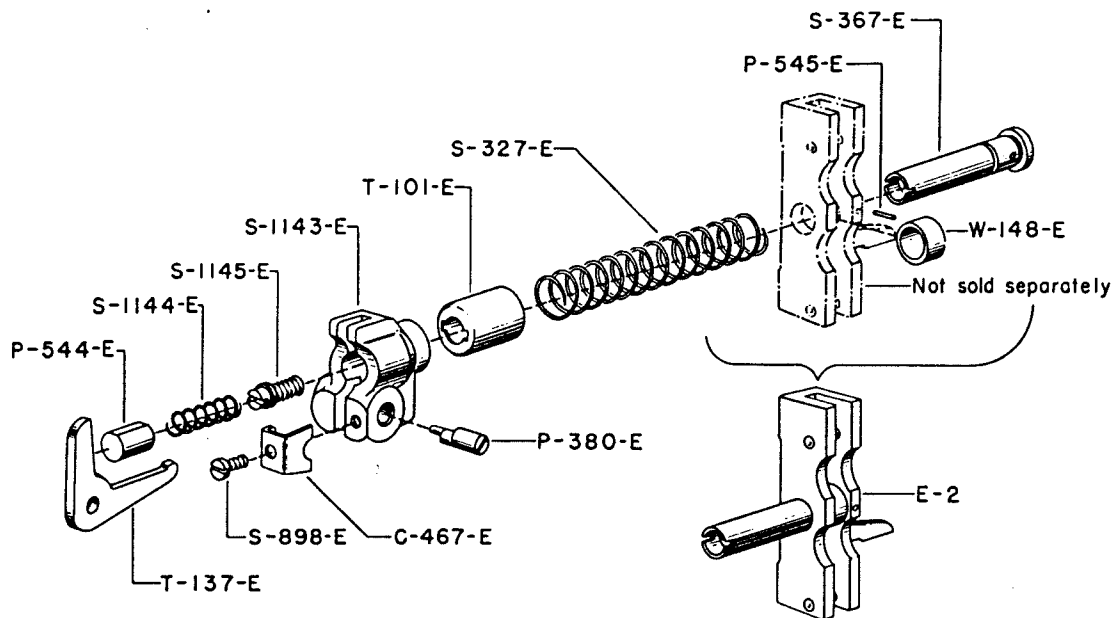

FILM TRAP DOOR HOLDER AND LOCK

ASSEMBLIES

E-2 FILM TRAP DOOR HOLDER AND STUD

P-545-E	Film Trap Door Holder Stud Retaining Pin
S-367-E	Film Trap Door Holder Stud
W-148-E	Film Trap Door Holder Stud Distance Washer

E-43 FILM TRAP DOOR LOCK

C-467-E	Film Trap Door Lock Pawl Pivot Clamp
P-380-E	Film Trap Door Lock Pawl Pivot
P-544-E	Film Trap Door Lock Plunger
S-898-E	Film Trap Door Lock Pawl Pivot Clamp Fastening Screw
S-1143-E	Film Trap Door Lock Trigger Support
S-1144-E	Film Trap Door Lock Plunger Spring
S-1145-E	Film Trap Door Lock Fastening Screw
T-137-E	Film Trap Door Lock Trigger

PARTS

S-327 E	Film Trap Door Holder Spring
T-101-E	Door Holder Thimble

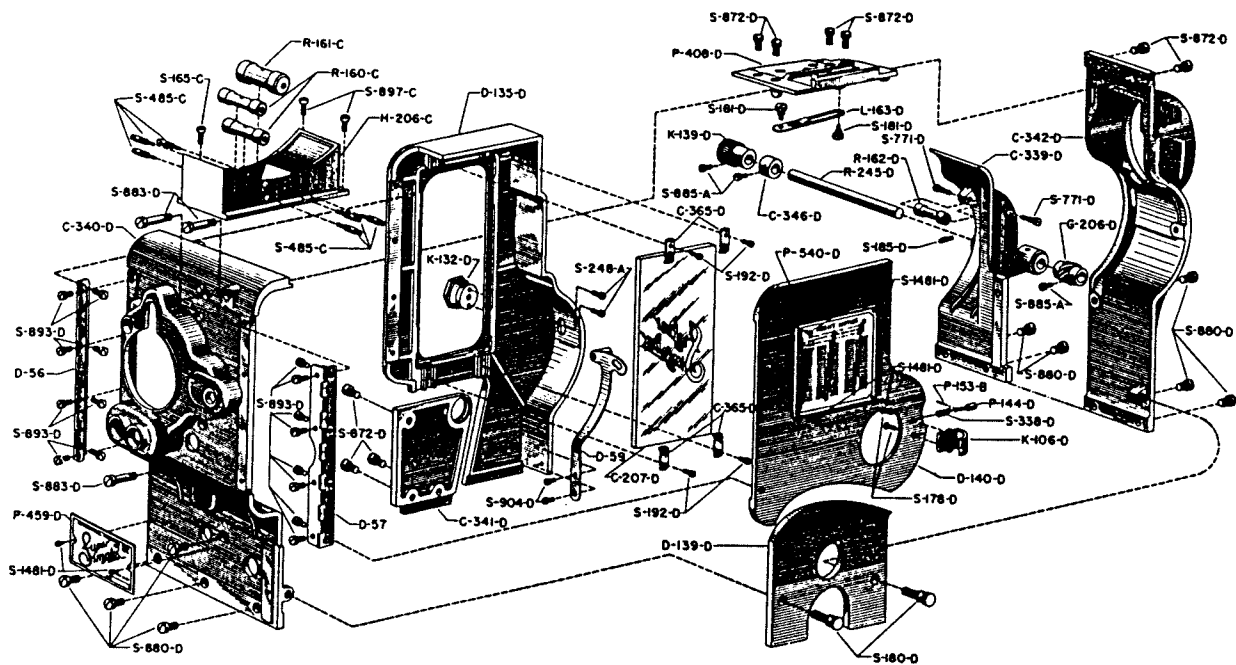

DOORS AND COVERS

ASSEMBLIES

C-17 UPPER MAGAZINE ROLLER HOLDER ASSEMBLY

- H-206-C Upper Magazine Roller Holder
- R-160-C Small Magazine Roller (2)
- R-161-C Large Magazine Roller
- S-485-C Magazine Roller Pivot Screw (6)

D-69 FILM SIDE REAR COVER ASSEMBLY

- C-339-D Film Side Rear Cover
- C-346-D Film Side Rear Cover Collar
- G-206-D Shutter Adjusting Gear
- K-139-D Shutter Adjusting Gear Knob
- R-162-D Film Side Rear Cover Stripper Roller
- R-245-D Shutter Adjusting Rod
- S-185-D Film Side Door Lock Stop Screw
- S-771-D Stripper Roller Screw (2)
- S-885-A Fastening Screw (for C-346-D, G-206-D and K-139-D) (3)

D-71 FILM SIDE DOOR ASSEMBLY

- C-365-D Film Side Door Glass Clamp (4)
- D-56 Film Side Door Hinge
- D-59 Film Side Door Lock Spring and Button
- D-135-D Film Side Door
- G-207-D Film Side Door Glass
- K-132-D Film Side Door Knob
- S-192-D Film Side Door Glass Clamp Screw (4)
- S-248-A Film Side Door Knob Fastening Screw (2)
- S-893-D Film Side Door Hinge Fastening Screw (4)
- S-904-D Film Side Door Lock Fastening Screw (2)

DOORS AND COVERS (continued)

D-72 GEAR SIDE UPPER DOOR ASSEMBLY

D-57	Gear Side Upper Door Hinge
D-140-D	Gear Side Upper Door
K-106-D	Gear Side Upper Door Knob
P-144-D	Gear Side Upper Door Lock Pin
P-153-B	Gear Side Upper Door Lock Plunger Pin
P-540-D	Name Plate - Patent Notice
S-178-D	Gear Side Upper Door Lock Screw (2)
S-338-D	Gear Side Upper Door Lock Pin Spring
S-893-D	Gear Side Upper Door Hinge Fastening Screw (4)

PARTS

C-340-D	Front Cover
C-341-D	Film Side Lower Cover
C-342-D	Gear Side Rear Cover
D-139-D	Gear Side Lower Door
L-163-D	Gear Side Upper Door Stop Link
P-408-D	Top Plate
P-459-D	Name Plate - Super-Simplex
S-165-D	Upper Magazine Roller Holder Fastening Screw (Front)
S-180-D	Gear Side Lower Door Retaining Screw (2)
S-181-D	Gear Side Upper Door Stop Link Screw (2)
S-872-D	Fastening Screw (for C-341-D, C-342-D and P-408-D) (9)
S-880-D	Fastening Screw (for C-339-D, C-340-D and C-342-D) (9)
S-883-D	Front Cover Fastening Screw (3)
S-893-D	Door Hinge Fastening Screw (8)
S-897-C	Upper Magazine Roller Holder Rear Fastening Screw (2)
S-1481-D	Name Plate Fastening Screw (6)

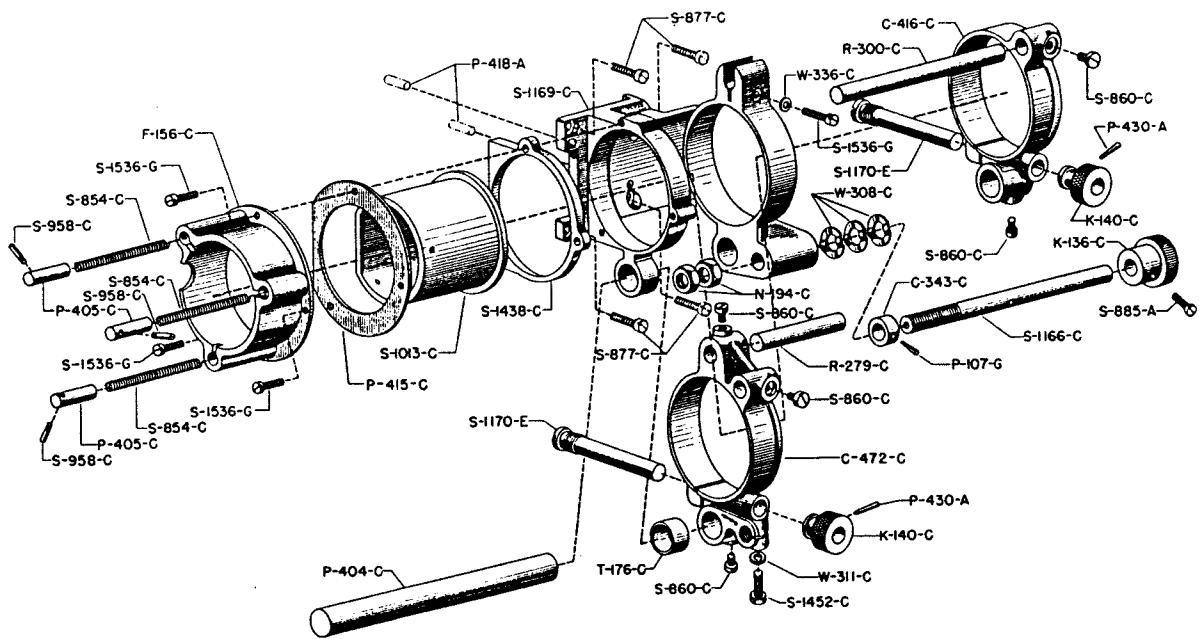

LENS HOLDER

LENS HOLDER

ASSEMBLIES

C-26 LENS SLIDE ASSEMBLY

F-156-C	Lens Slide Flange
P-405-C	Lens Slide Guide Pin (3)
P-415-C	Lens Slide Plate
S-854-C	Lens Slide Spring (3)
S-958-C	Lens Slide Guide Pin Screw (3)
S-1013-C	Lens Slide

C-44 LENS CARRIER ADJUSTING SCREW ASSEMBLY

C-343-C	Lens Carrier Adjusting Stop Collar
P-107-G	Stop Collar Taper Pin
S-1166-C	Lens Carrier Adjusting Screw

C-45 LENS CLAMP SCREW AND KNOB ASSEMBLY (2)

K-140-C	Lens Clamp Screw Knob
P-430-A	Lens Clamp Screw Knob Taper Pin
S-1170-E	Lens Clamp Screw

PARTS

C-416-C	Front Lens Carrier
C-472-C	Rear Lens Carrier
K-136-C	Lens Carrier Adjusting Knob
N-194-C	Adjustable Flange Lock Nut (2)
P-404-C	Lens Carrier Pivot
P-418-A	Lens Carrier Support Dowel Pin (2)
R-279-C	Lens Carrier Upper Guide Rod
R-300-C	Lens Carrier Tie Rod
S-860-C	Lens Carrier Set Screw (5)
S-877-C	Lens Carrier Support Fastening Screw (4)
S-885-A	Lens Carrier Adjusting Knob Fastening Screw
S-1169-C	Lens Carrier Support
S-1438-C	Lens Slide Flange Spacer
S-1452-C	Lens Carrier Support Friction Screw
S-1536-G	Screw (for S-1169-C and S-1438-C) (4)
T-176-C	Lens Carrier Stop Tube
W-308-C	Focusing Shaft Spring Washer (3)
W-311-C	Friction Screw Lock Washer (for S-1452-C)
W-336-C	Lock Washer



LIKE ALL fine precision machines, SIMPLEX projectors require proper periodic lubrication to continue functioning at peak efficiency.

To assure that this lubrication is exactly suited to the job it has to do, SIMPLEX engineers have had SIMPLEX OIL and SIMPLEX REAR SHUTTER GREASE especially compounded for use in SIMPLEX mechanisms.

For your protection, ask for genuine SIMPLEX OIL and SIMPLEX REAR SHUTTER GREASE—the perfect SIMPLEX lubricants, in the yellow and black containers!

