

# Film-Tech

The information contained in this Adobe Acrobat pdf file is provided at your own risk and good judgment.

These manuals are designed to facilitate the exchange of information related to cinema projection and film handling, with no warranties nor obligations from the authors, for qualified field service engineers.

If you are not a qualified technician, please make no adjustments to anything you may read about in these Adobe manual downloads.

[www.film-tech.com](http://www.film-tech.com)

# Neutaper

## Film Splicer

### INSTRUCTIONS for USE

1. Lift top jaw assembly to upright position - place roll of Neutape in splicer.
2. Using sprocket pins at right hand end of splicer bed, position film for straight splice so that frame line is centered over lower cutting blade (on diagonal model, place film accordingly). Trim right and then left hand film and position in splicer bed on center pins only, using red mark to locate ends of film butted together.

If dirt or oil is on the film in splice area, wipe with clean cloth to insure maximum tape adhesion.

3. Pull tape from supply roll across film lining up the tape with edge marks on front guide bracket. Press tape onto film to eliminate any air bubbles.
4. Lower top jaw assembly and press hand lever to full downward position. (This will trim tape at both edges of the film and perforate sprocket holes in tape). Lift top jaw assembly and again press tape to film across entire splice area.
5. Remove film from splicer, flip over to repeat Steps 3 and 4. This will produce a smooth, stable splice with tape on both sides of the film.

NOTE: On Model 16-SW (Wrap Around), after Step 2, position trimmed film emulsion up and apply tape as in Step 3. Trim and punch as in Step 4. Lift film from splicer, fold over perforated tab extension, wrapping tape around other side of film.

### MAINTENANCE SUGGESTIONS

1. To take full advantage of maximum trim blade life, remove accumulated tape "trimmings" from front tape guide. If using other than Neutape, there may be an adhesive build up on front and back blades - this should be removed as well as any residue on front and back tape guides.
2. When replacing trim blades, DO NOT adjust blade holder. Trim blade must not touch lower matrix - there should be no metal to metal contact.

PLACE ORDER NOW for ADDITIONAL ROLLS of NEUTAPE  
CLEAR or YELLOW OPAQUE

16mm Neutape	\$1.95/roll	12 rolls per Package
35/70 Neutape	\$2.85/roll	8 rolls per Package

FOR BEST RESULTS and a PERFECT SPLICE EVERY TIME, USE  
NEUTAPE SPLICING TAPE

Est.  
1916

# Neumade

PRODUCTS CORPORATION

BOX 568, 720 WHITE PLAINS RD., SCARSDALE, N.Y. 10583

**Now!**

*NeuTape* FOR PHOTOGARD

For best Splicing results on film treated with 3M Photogard, be sure to use our specially developed splicing tape for Photogard (clear only).

16MM

PHG-16 NEUTAPE  
\$3.20/Roll  
(10 Pkg.)

35MM

PHG-35 NEUTAPE  
\$4.40/Roll  
(8 Pkg.)

# NewTaper SPLICER

## REPLACEMENT PARTS

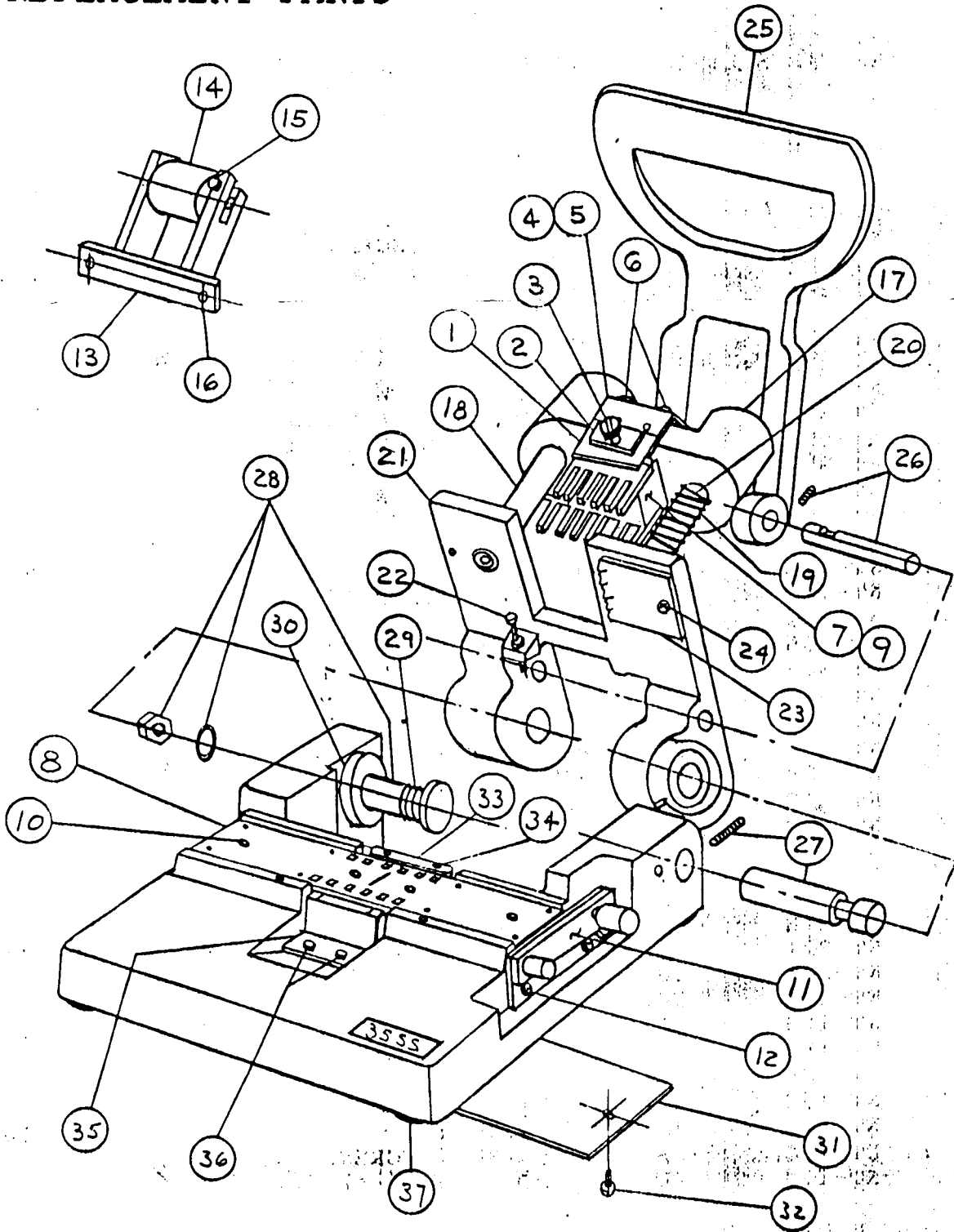

Est.  
1918

# Newmade

PRODUCTS CORPORATION

200 Connecticut Ave. P.O. Box 5001 Norwalk, CT. 06856

# NEUMADE PRODUCTS CORPORATION

200 CONNECTICUT AVENUE/P.O. BOX 5001/NORWALK, CT 06856  
 (203) 866-7600 FAX (203) 866-7522



*Neumade*

SINCE 1916

APRIL 1, 1991

## 35MM PARTS LIST -- MODELS #35-SS....#35-DS....#35-SDS

REF. NO.	PART NO.	DESCRIPTION	PRICE
1	NT-6B	TAPE CUTTER BLADE	\$ 5.95
2	NT-7B	BLADE PRESSURE PLATE	3.90
3	NT-8	BLADE POSITIONING SCREW	5.20
4	NT-1B	REAR BLADE HOLDER	24.50
5	NT-2B	FRONT BLADE HOLDER	24.50
6	NT-2C	BLADE HOLDER SCREW & WASHER	.60
7	NT-35PB	35MM PERF PUNCH	
8	NT-35DB	35MM PERF DIE (SOLD AS SET ONLY)	212.00/set
9	NT-35PC	PUNCH MOUNTING SCREW	.70
10	NT-35DC	DIE MOUNTING SCREW & WASHER	.60
11	NT-9B	FILM CUTTER ASSEMBLY (35-SS & 35-DS)	74.50
	NT-9BS	STRAIGHT FILM CUTTER FOR #35-SDS	76.00
	NT-9BD	DIAGONAL FILM CUTTER FOR #35-SDS	74.50
12	NT-9C	FILM CUTTER MOUNTING SCREW & 2 SPACERS	.80
13	NT-16B	TAPE HOLDER BRACKET	38.00
14	NT-12B	TAPE HOLDER ROLLER	23.00
15	NT-12C	TAPE ROLLER RETAINER ASSEMBLY	13.50
16	NT-16C	TAPE HOLDER MOUNTING SCREW	.45
	NT-28B	COMPLETE SECOND TAPE HOLDER ADD-ON KIT	59.00
17	NT-3B	PERFORATOR PUNCH BASE	84.00
18	NT-38L	LH GUIDE POST W/BOLT & WASHER	22.00
19	NT-38R	RH GUIDE POST W/BOLT & WASHER	22.00
20	NT-4	GUIDE POST SPRING	7.90
21	NT-22B	UPPER JAW	110.00
22	NT-11C	HANDLE STOP SCREW & NUT	.90
23	NT-21B	STRIPPER PLATE	32.00
24	NT-21C	STRIPPER PLATE SCREW & SPACER	.60
25	NT-11	HANDLE	68.00
26	NT-4H	HANDLE PIVOT PIN & SET SCREW	8.90
27	NT-22H	UPPER JAW PIVOT PIN & SET SCREW	9.50
28	NT-221	UPPER JAW PIVOT ARBOR BOLT SPACER & NUT	39.00
29	NT-225	UPPER JAW SPRING	5.40
30	NT-224	UPPER JAW SPACER	12.00
31	NT-18B	BASE CLEAN-OUT PLATE	15.00
32	NT-18C	PLATE MOUNTING SCREW	.45
33	NT-13B	REAR TAPE GUIDE	9.50
34	NT-13C	REAR TAPE GUIDE SCREW	.45
35	NT-15B	FRONT TAPE GUIDE	10.50
36	NT-15C	FRONT TAPE GUIDE SCREW	.45
37	NT-17B	RUBBER FEET (SET OF 4)	4.80

\* \$25.00 NET MINIMUM ORDER