

Film-Tech

The information contained in this Adobe Acrobat pdf file is provided at your own risk and good judgment.

These manuals are designed to facilitate the exchange of information related to cinema projection and film handling, with no warranties nor obligations from the authors, for qualified field service engineers.

If you are not a qualified technician, please make no adjustments to anything you may read about in these Adobe manual downloads.

www.film-tech.com

FILM TAKE-UP AND LOWER CASTOR

ITEM	PART NO.	DESCRIPTION
1	1524-04-0	Variac Linkage Assembly
2	1455-07-4	3 Platter Column (Not Sold Separately)
3	1071-03-1	10-32 x 3/8 Truss Head Screw
4	1078-03-1	No. 10 Lockwasher
5	1236-07-0	Upper Take-up Bracket
6	1050-03-1	E Ring
7	1238-07-0	Take-up Rails
8	1462-05-3	Pulley Assembly
9	1447-05-3	Castor Shaft, Pulley Assembly
10	1055-03-1	1/4-28 x 1/2 Hex Bolt
11	1134-05-0	Take-up Roller
12	1056-03-1	1/4-28 x 3/4 Hex Bolt
13	1135-05-1	Take-up Roller Shaft
14	1079-03-1	1/4 Lockwasher
15	1460-07-3	Castor Mount Bearing Assembly
17	1087-03-1	1/4-28 Hex Nut
18	1076-03-1	1/4 Flatwasher
19	1119-04-0	Take-up Plate Weight
20	1118-04-0	Take-up Plate
21	1234-07-1	Stop Pin Spring
22	1465-07-3	Take-up Stop Pin & Knob Assembly
23	1230-07-0	Take-up Stop Bracket
24	1231-07-0	Take-up Slide Spring Spacer
25	1229-07-1	Take-up Slide Spring
26	1129-05-1	Castor Pulley Shaft
27	1140-05-0	Left Castor Swivel Bracket
29	1136-05-1	Keeper Shaft
30	1448-05-3	Spool Assembly
31	1056-03-1	1/4-28 x 3/4 Hex Bolt
32	1170-07-0	Bottom Pulley Bracket
33	1237-07-0	Lower Take-up Bracket
34	1086-03-1	10-32 Hex Nut
35	1174-07-1	3/8" Hole Plug
36	1125-04-0	Variac Linkage Spacer
37	1104-03-1	1/4-20 x 1 SHCS

2581

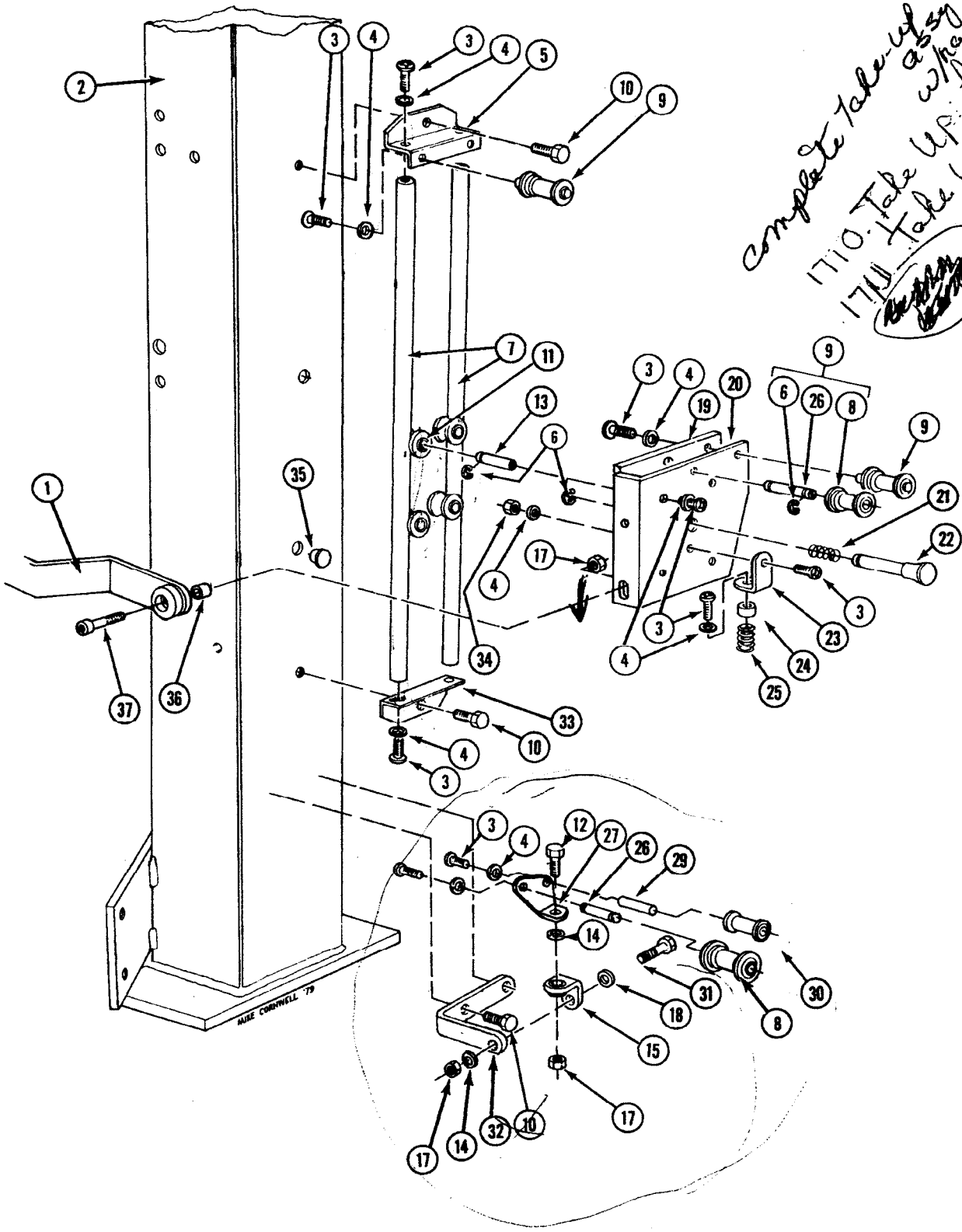

Complete take up assembly with 1710. Take up: AS P. 1711. Take up AS P.

JUNE CORNWELL '79

ARM AND MOTOR

ITEM	PART NO.	DESCRIPTION
1	1516-04-3	Arm Assembly, 48" Disk
	1517-04-3	Arm Assembly, 48" Variac Mount
2	1518-04-3	Arm Assembly, 52" Disk
	1519-04-3	Arm Assembly, 52" Variac Mount
3	1062-03-1	5/16-18 x 5 Hex Bolt
4	1080-03-1	5/16 Lockwasher
5	1090-03-1	Hex Nut, 5/16-18
6	1107-04-0	Motor Support Arm
7	1076-03-1	Flatwasher, 1/4"
8	1055-03-1	Hex Bolt, 1/4-28 x 1/2
9	1520-04-1	Rubber Grommet
10	1103-03-1	1/4-28 x 1 1/4 SHCS
11	1087-03-1	1/4-28 Hex Nut
12	1522-04-3	Motor Assembly
13	1003-01-1	Resistor, 2 OHM
14	1011-01-1	Motor Toggle Switch
15	1002-01-1	Diode
16	1115-04-0	Motor Cover
17	1046-02-1	Resistor, 10 OHM
18	1018-01-1	Motor Plug
19	1521-04-1	Flat Drive Belt

VARIABLE TRANSFORMER AND LINKAGE

ITEM	PART NO.	DESCRIPTION
1	1389-15-1	Variac, 3PN-1010
2	1523-04-1	Switch
3	1524-04-0	Variac Linkage Assembly
4	1104-03-1	1/4-20 x 1 SHCS
5	1079-03-1	Lockwasher, 1/4"
6	1105-03-1	Hex Nut, 1/4-20
7	1017-01-1	Variac/Table Plug

